

Note:

1. Material: Insulator: See note 2

Terminal: Copper alloy

Material for plastic:

Insulator: PA66+30% G/F UL94V-0 Color: Nature

2. Contact:

Tin Plated 120 u" over Ni 30 u" min

Silver Plated 80~120 u" over Ni 30 u" min

3. Compliant IEC 60695-2-11 and IEC 60335-1

(750°C, Flamme<2S)

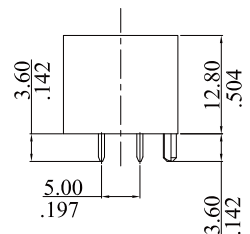
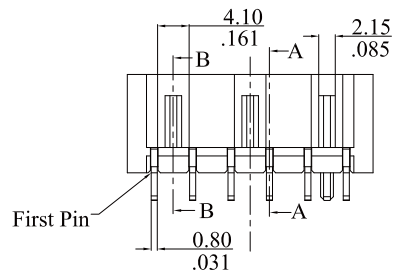

SECTION A-A

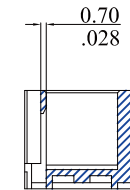

SECTION B-B

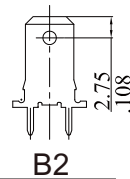
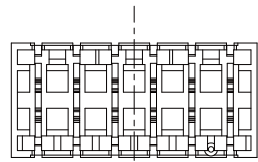

B2

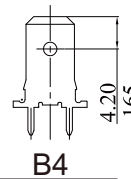

B4

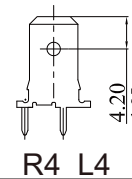

R4 L4

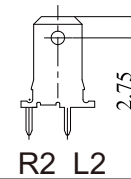

R2 L2

12	62.0(2.441)	55.0(2.165)	60.2(2.370)
11	57.0(2.244)	50.0(1.969)	55.2(2.173)
10	52.0(2.047)	45.0(1.712)	50.2(1.975)
9	47.0(1.850)	40.0(1.575)	45.2(1.780)
8	42.0(1.654)	35.0(1.378)	40.2(1.583)
7	37.0(1.457)	30.0(1.181)	35.2(1.386)
6	32.0(1.260)	25.0(.984)	30.2(1.189)
5	27.0(1.063)	20.0(.787)	25.2(.992)
4	22.0(.886)	15.0(.591)	20.2(.795)
3	17.0(.669)	10.0(.394)	15.2(.598)
2	12.0(.472)	5.0(.197)	10.2(.402)
CIRCUITS	DIM.A	DIM.B	DIM.C

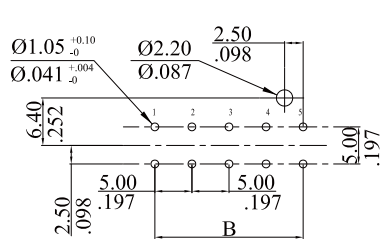

B Type PCB layout

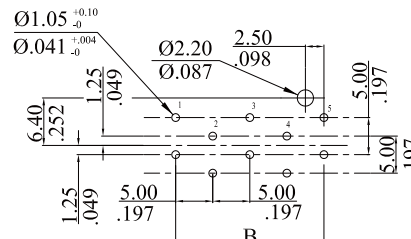

R Type PCB layout

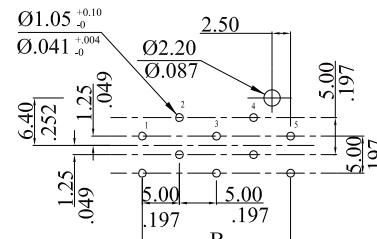

L Type PCB layout

RoHS Compliant

TOLERANCES ARE

MORETHANALL
PCB CONNECTORS
Cable ASSEMBLIES

DRAWING BY CY

CHECKED BY GENIUS

UNIT / mm SCALE 1 : 1

DATE

SIZE A4

X, ±
X ± 0.30
.XX ± 0.20
.XXX ± 0.10
ANG ± 1°

P PROJECTION

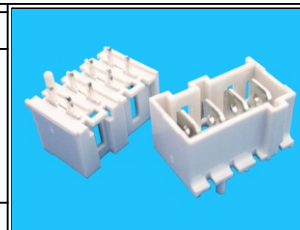

ORDER INFORMATION

RST50-PDPxy-xx0yy-LF

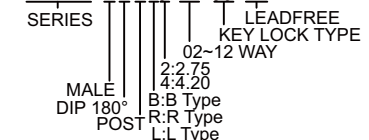

煜倫股份有限公司

www.morethanall.com

DESCRIPTION:

TYPE	0A	0B	0C	0D	0E	0F	0G	0H	0I	0J	0K	0L	0M	0N
KEY/LOCK 2-way														

--	--	--	--	--	--	--	--	--	--	--	--	--	--

TYPE	0A	0B	0C	0D	0E	0F	0G	0H	0I	0K	0L
KEY/LOCK 3-way											

--	--	--	--	--	--	--	--	--	--	--

--	--	--	--	--	--	--	--	--	--	--

--

TYPE	0A	0B	0C	0D	0E	0F	0G	0H	0I
KEY/LOCK 4-way									

--	--	--	--	--	--	--	--	--

--	--	--	--	--	--	--	--	--

--	--	--	--	--	--	--

2~4 KEY WAY

RoHS Compliant

TOLERANCES ARE

MORETHANALL
PCB CONNECTORS
Cable ASSEMBLIES

DRAWING BY CY

CHECKED BY GENIUS

UNIT / mm SCALE 1 : 1

DATE

SIZE A4

X, ±
.X ± 0.30
.XX ± 0.20
.XXX ± 0.10
ANG ± 1°

P PROJECTION

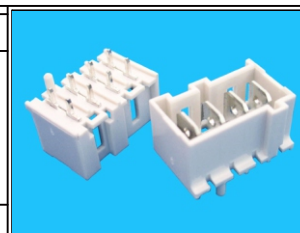

ORDER INFORMATION

RST50-PDPxy-xx0yy-LF

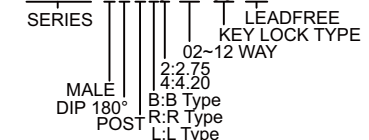

煜倫股份有限公司

www.morethanall.com

DESCRIPTION:

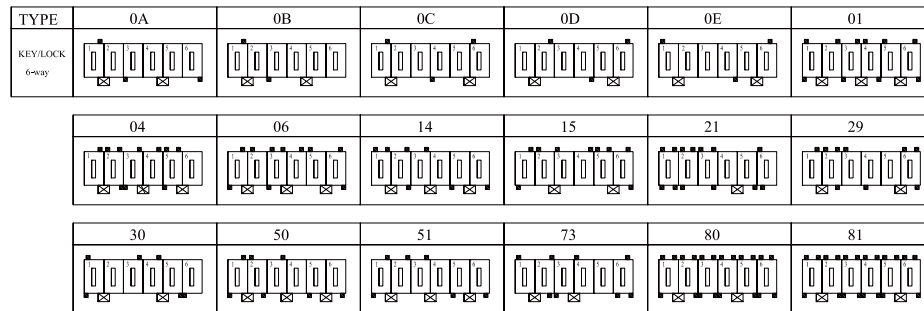
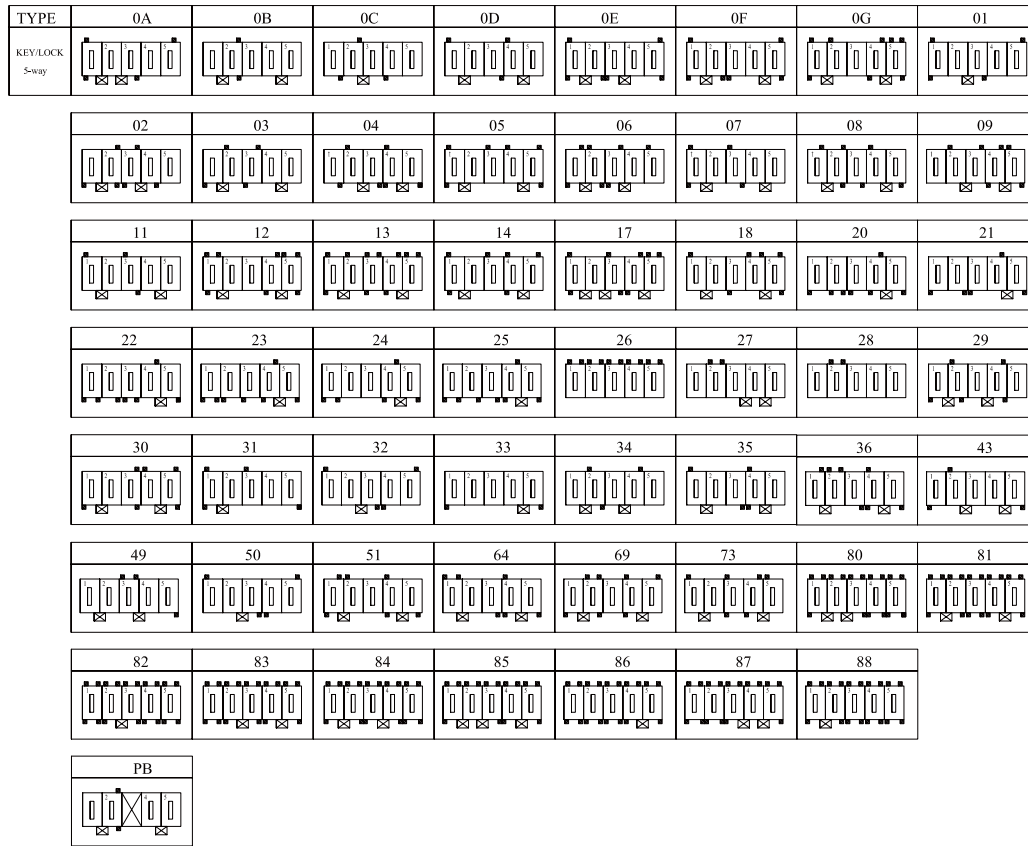

5~6 KEY WAY

MORETHANALL
PCB CONNECTORS
Cable ASSEMBLIES

煜倫股份有限公司

www.morethanall.com

RoHS Compliant

DRAWING BY CY

CHECKED BY GENIUS

UNIT / mm SCALE 1 : 1

DATE

SIZE A4

TOLERANCES ARE

X, ±
.X ± 0.30
.XX ± 0.20
.XXX ± 0.10
ANG ± 1°

PJECTION

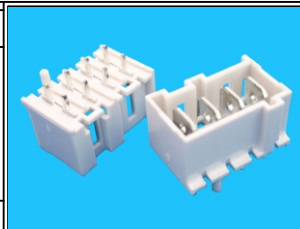

ORDER INFORMATION

RST50-PDPxy-xx0yy-LF

SERIES | | | | | LEADFREE
KEY LOCK TYPE
02~12 WAY
2:2.75
4:4.20
MALE B:B Type
DIP 180° R:R Type
POST L:L Type

DESCRIPTION:

TYPE	0A	0B	1B	0C	0D	0E
KEYLOCK 7-way						
	03					
	04	14	22	23	27	30
	31	32	34	35	38	40
	41	42	43	45	48	51
	59	69	76	80	81	83

TYPE	0A	0C	0D	0E	0F	08
KEYLOCK 8-way						
	10	16	21	30	33	41
	44	45	46	48	49	57
	58	62	63	77	80	81

TYPE	0A	0B	0C	0D	08
KEYLOCK 9-way					
	31	42	43	48	49
	52	53	57	58	
	80	81			

7~9 KEY WAY

MORETHANALL
PCB CONNECTORS
Cable ASSEMBLIES

煜倫股份有限公司

www.morethanall.com

RoHS Compliant

DRAWING BY CY

CHECKED BY GENIUS

UNIT / mm SCALE 1 : 1

DATE

SIZE A4

TOLERANCES ARE

X, ±
.X ± 0.30
.XX ± 0.20
.XXX ± 0.10
ANG ± 1°

P PROJECTION

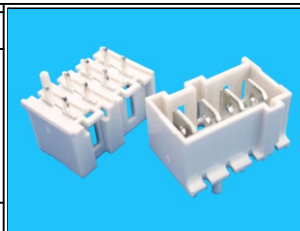

ORDER INFORMATION

RST50-PDPxy-xx0yy-LF

SERIES | | | | | LEADFREE
KEY LOCK TYPE
02~12 WAY
2:2.75
4:4.20
MALE B:B Type
DIP 180° R:R Type
POST L:L Type

DESCRIPTION:

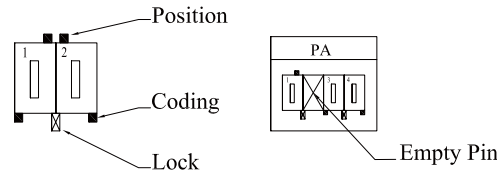
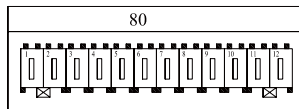
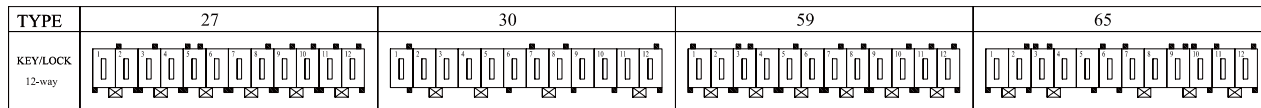
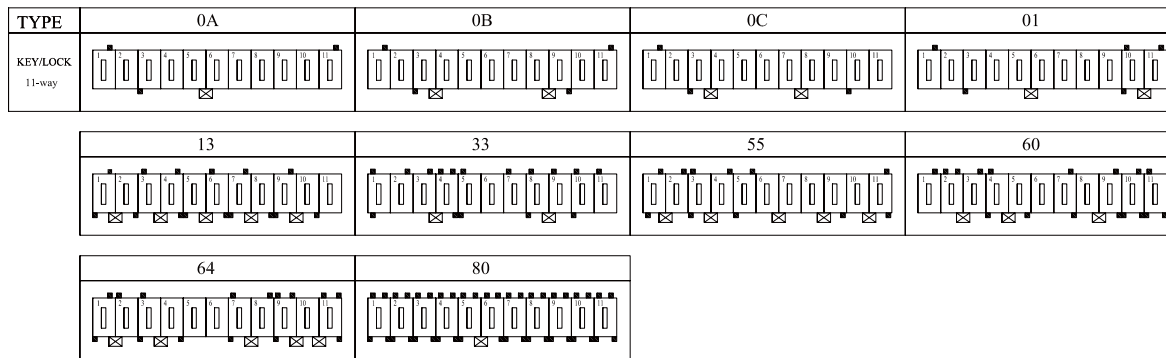
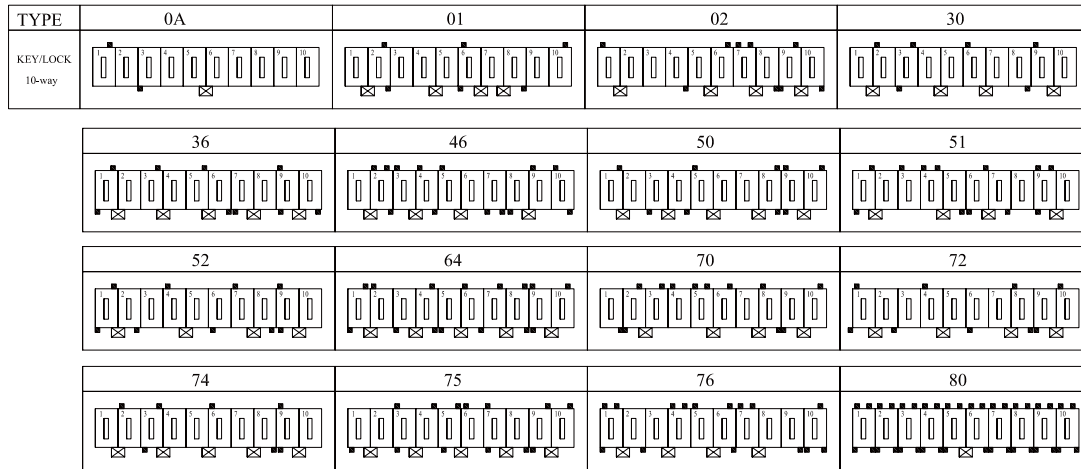

10~12 KEY WAY

RoHS Compliant

TOLERANCES ARE

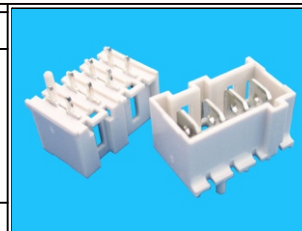

DRAWING BY CY

CHECKED BY GENIUS

UNIT / mm SCALE 1 : 1

DATE

SIZE A4

X, ±
.X ± 0.30
.XX ± 0.20
.XXX ± 0.10
ANG ± 1°

PJECTION

ORDER INFORMATION

RST50-PDPxy-xx0yy-LF

SERIES
MALE
DIP 180°
POST
LEADFREE
KEY LOCK TYPE
02~12 WAY
2:2.75
4:4.20
B:B Type
R:R Type
L:L Type

DESCRIPTION:

MORETHANALL
PCB CONNECTORS
Cable ASSEMBLIES

煜倫股份有限公司

www.morethanall.com