

产品说明 Product Description:

- 1.表面处理 Surface treatment:  
电镀Sn(雾锡) Matte tin plating
- 2.外观 Appearance:  
>30CM距离, <5S目视, 无腐蚀、刮伤、氧化  
No corrosion, scratches, oxidation on surface  
Inspection condition:  
Inspect from >30cm away and for <5 seconds
- 3.盐雾测试 Salt spray test:  
24h, 等级7级(GB)  
24 hours, grade 7 (GB)
- 4.环保: 符合ROHS&REACH  
RoHS&REACH compliance: Yes
- 5.备注 Note:  
拉力测试:  
1.首次插入力≤7.8kg,  
2.首次拉力 > 0.7kg

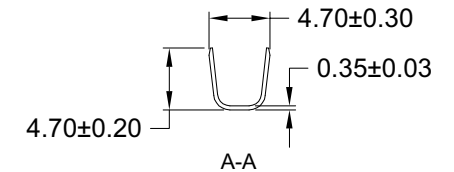
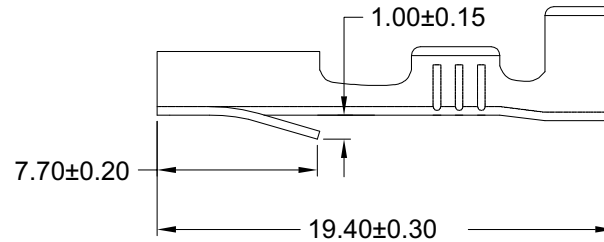
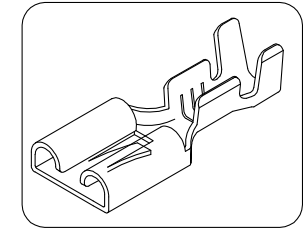

电线导体规格  
Conductor 12~16AWG

材质  
Material 黄铜Brass(C2680)

包装数量  
Packing Q' TY 5000Pcs/Reel

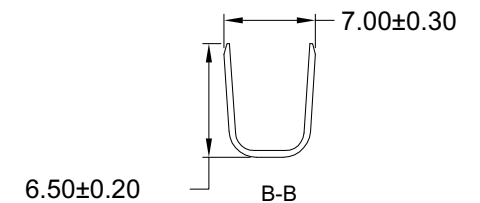
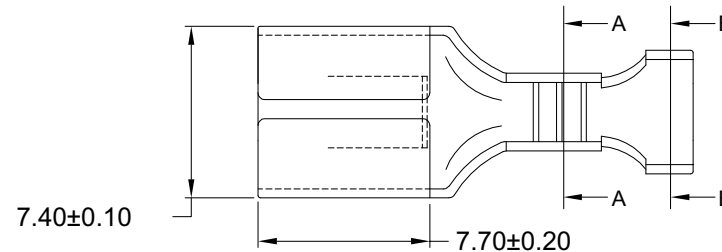

RoHS Compliant

TOLERANCES ARE

**MORETHANALL**  
PCB CONNECTORS  
Cable ASSEMBLIES

DRAWING BY CY

X, ±  
.X ± 0.20  
.XX ± 0.10  
.XXX ± 0.05  
ANG ±

CHECKED BY GENIUS

UNIT / mm SCALE 1 : 1

DATE

SIZE A4

PPOJECTION

照片框

ORDER INFORMATION

Q250-FT8LK-12-LF  
SERIES | | | | | LEADFREE  
| | | | | 12~16AWG  
| | | | | LOCK  
| | | | | 0.8t  
| | | | | TERMINAL  
| | | | | FEMALE

煜倫股份有限公司

www.morethanall.com

DESCRIPTION: