

MATERIAL

INSULATION: NYLON

MATERIAL: BRASS

TIN PLATING

MAXIMUM ELECTRIC CURRENT

A. W. G	22	20	18	16	14	12	10
MAX AMP	3	4	7	10	15	20	24

NOTE:

MAXIMUM ELECTRICAL RATING: 105°C 300 VOLTS

1. WIRE RANGE: 22-16 AWG / 0.5-1.5 mm²

INSULATED COLOR: RED

2. WIRE RANGE: 16-14 AWG / 1.5-2.5 mm²

INSULATED COLOR: BLUE

3. WIRE RANGE: 12-10 AWG / 4-6 mm²

INSULATED COLOR: YELLOW

4. MATERIAL THICKNESS: t

TOLERANCE: ±0.05

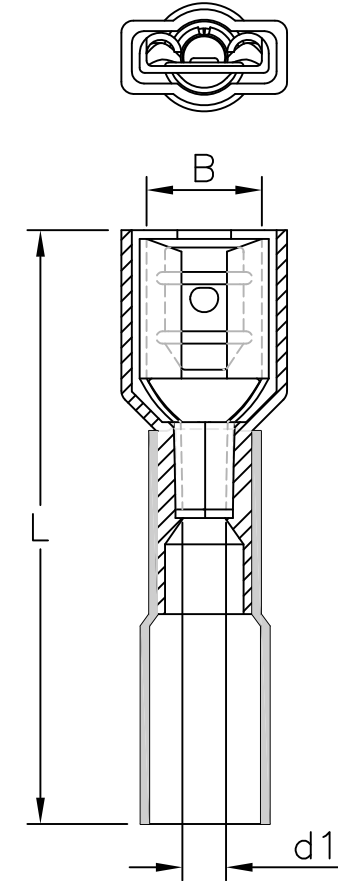

WIRE RANGE AWG/mm ²	產品編號 ITEM NO.	NEMA TAB	B ±0.20	L ±2.00	d1 ±0.20	t
22-16 AWG 0.5-1.5 mm ²	Q250-FT8HTNFK-16	0.8x6.4	6.6	36.5	1.7	0.4
16-14 AWG 1.5-2.5 mm ²	Q250-FT8HTNFK-14	0.8x6.4	6.6	36.5	2.3	0.4
12-10 AWG 4-6 mm ²	Q250-FT8HTNFK-10	0.8x6.4	6.6	37.0	3.4	0.4

RoHS Compliant

TOLERANCES ARE

MORETHANALL
PCB CONNECTORS
Cable ASSEMBLIES

煜倫股份有限公司

www.morethanall.com

DRAWING BY CY

CHECKED BY GENIUS

UNIT / mm

SCALE 1:1

DATE

SIZE A4

X. ±

.X ±

.XX ±

.XXX ±

ANG ±

P PROJECTION

照片框

ORDER INFORMATION

Q250-FT8HTNFK-xx-LF

SERIES | | | | | LEADFREE

FEMALE | | | | | 16:22-16 AWG

TERMINAL | | | | | 14:16-14 AWG

THICKNESS 0.8mm | | | | | 10:12-10 AWG

HEAT TUBE | | | | | K TYPE

NYLON FULL

DESCRIPTION: