

說明:  
 1 預鍍霧錫膜厚40u"以上  
 2 對手件: 060型 TAB=0.6  
 插入力:0.35-1.0KG  
 拉拔力:0.35-1.0KG

NOTE:  
 1 Pre-Matt Tin Plated Thickness More Than 40u"  
 2 Mating Part: 060-Type Tab=0.6  
 Inserted Force:0.35-1.0KG  
 Tensile Force:0.35-1.0KG

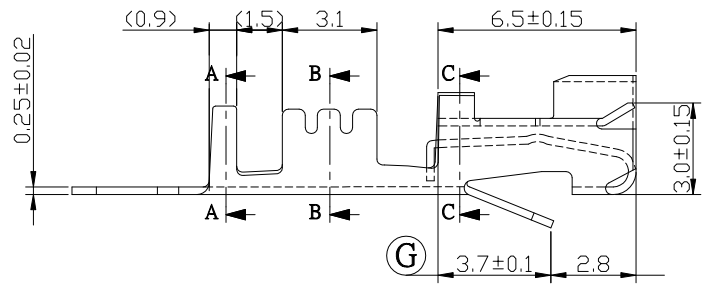

(G尺寸量測點在最上端)

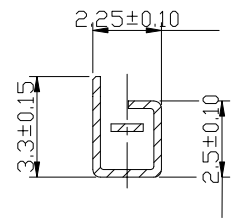
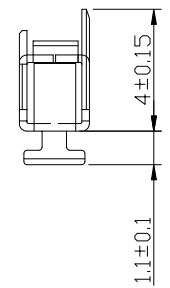

SEC.C-C

2	Phosphor Bronze	Note 1	0.85mm
1	Phosphor Bronze	Note 1	0.85mm <sup>2</sup>
NO.	材料 Material	表面處理 Surface Treatment	線徑 Wire Range

RoHS Compliant

TOLERANCES ARE

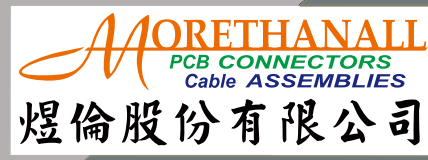

DRAWING BY CY  
 CHECKED BY GENIUS  
 UNIT / mm SCALE 1 : 1  
 DATE

X, ±  
 .X ±  
 .XX ±  
 .XXX ±  
 ANG ±

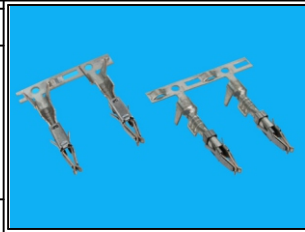

ORDER INFORMATION

Q060T-FT-18-LF  
 SERIES | | LEADFREE  
 | | 18 AWG  
 | | TERMINAL  
 | | FEMALE

www.morethanall.com

SIZE A4 PROJECTION

DESCRIPTION: 060 TYPE FEMALE TERMINAL