

- NOTES:  
 1.SCREW AND WASHER TO BE SHIPPED UNASSEMBLED IN A SEPARATE BAG  
 2.NO PLATING ON EDGES SHOWN  
 3.MATERIAL:  
 CONNECT:COPPER ALLOY PLATING:NI,BRIGHT TIN.  
 HOUSING:THERMOPLASTIC HIGH TEMP UL94V-0  
 WASHER:STEEL PLATING Ni  
 SCREW :COPPER ALLOY  
 4.CURRENT RATING :36AMP.@30°C  
 5.OPERATING TEMPERATURE RANGE:-55°C TO +105°C

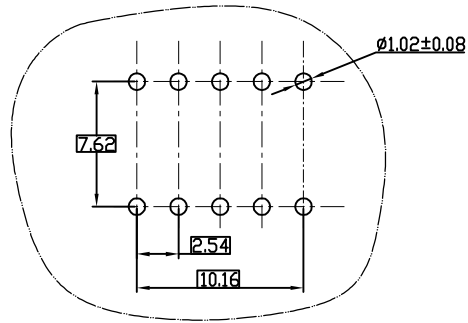
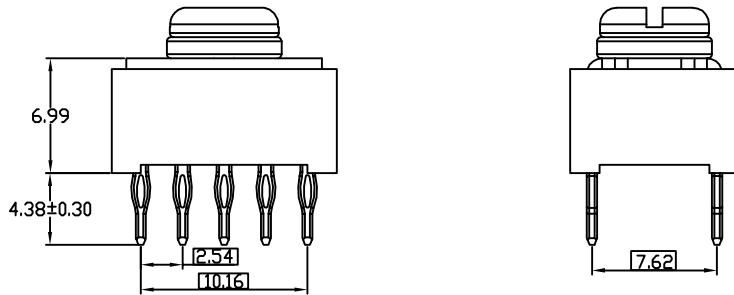

P.C. BOARD  
HOLE PATTERN

PWT-P632YL-0310-LF  
LEADFREE

RoHS Compliant

**MORETHANALL**  
CONNECTORS  
ASSEMBLIES

PART NO. PWT-P632YL-0310

DWG NO. PWT-P632YL-0310

CHECKED BY CY

TOLERANCES ARE

X.±  
.X±  
.XX±  
.XXX±  
ANG

DESCRIPTION:

POWER TERMINAL  
10 PIN ASSY

FILE NO.

DRAWING BY

AREA

REVISIONS

DATE

UNIT / mm

SCALE 1:1

PROJECTION



煜倫股份有限公司