

Specifications:

Current rating:5.0 AC/DC

Voltage rating:250V AC/DC

Contact resistance:20m ohm. max.

Insulator resistance:1000M ohm. Min.

Withstanding voltage:1500V AC for one minute

Operating temperature range:-25°C to + 105°C

Application wire:AWG#26 TO #18

Material and Finish:

Insulator:high Temp. Plastic(UL94V-2)

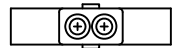
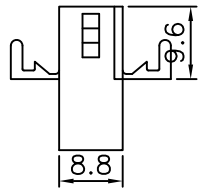
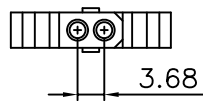

PS-SE-1X02

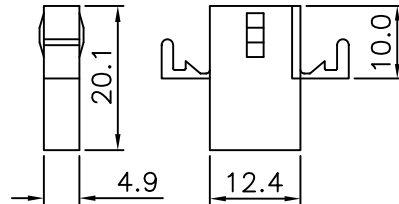
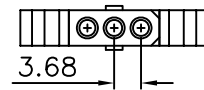

PS-SE-1X03

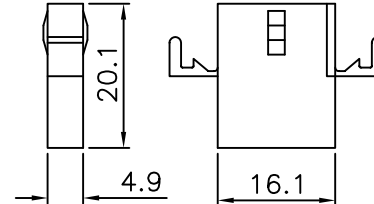
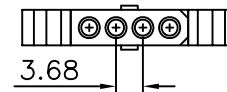

PS-SE-1X04

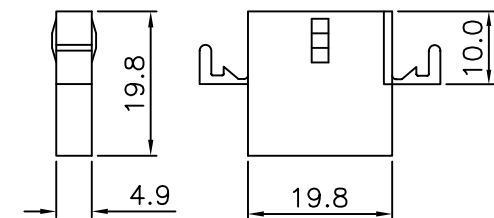
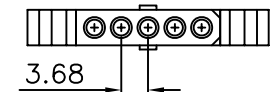

PS-SE-1X05

RoHS Compliant

TOLERANCES ARE

MORETHANALL
PCB CONNECTORS
Cable ASSEMBLIES

煜倫股份有限公司

www.morethanall.com

DRAWING BY CY

CHECKED BY GENIUS

UNIT / mm SCALE 1 : 1

DATE

SIZE A4

X, ±

.X ±

.XX ±

.XXX ±

ANG ±

P PROJECTION



ORDER INFORMATION

PS-SE-1Xxx-LF

SERIES PS-SE-1Xxx-LF
LEADFREE
1X02:02 WAY
1X05:05 WAY
EAR
FEMALE HOUSING

DESCRIPTION: