

POSITIONS	02 PIN	03 PIN	04 PIN	05 PIN	06 PIN	07 PIN	08 PIN	10 PIN	14 PIN	16 PIN
VIEW FROM TERMINATION SIDE PIN PART										

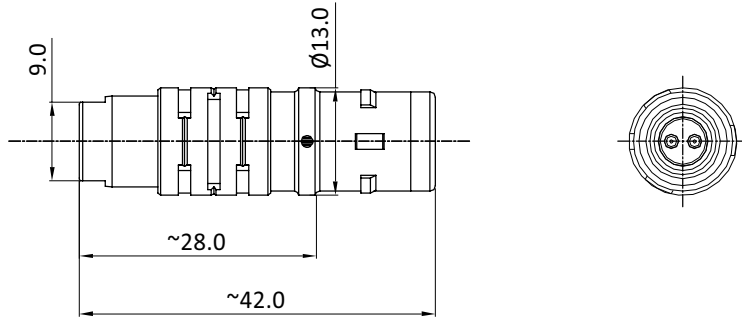

NOTE:

- Material and finish
 Outer shell & Back nut: Copper alloy, Cr plating
 Contact: Copper alloy, Gold plating over Ni
 Insulator: PEEK UL94 V-1
 Gasket: FKM
 Other parts: Copper alloy, Ni plating
- Mechanical characteristics
 Insertion Force: 29.4N MAX.
 Extraction Force: 29.4N MAX.
 Back nut torque: 0.8 N·m MAX.
 Endurance: 5000 mating cycles
 Vibration: 10-2000Hz , 15g comply with EIA-364-28
 Shock: 100g amplitude, half sine pulse of 3ms,
 no discontinuity > 1us EIA-364-27
- Electrical specifications
 Contact resistance: 8.7 mOhm MAX.
 After 5000 Cycles: 10 mOhm MAX.
 Insulation resistance: >100 Mohm
 Rated current: 2PIN 15.0A(Per Pin) 3PIN 12.0A(Per Pin)
 4PIN 10.0A(Per Pin) 5PIN 9.0A(Per Pin)
 6&7PIN 7.0A(Per Pin) 8PIN 5.0A(Per Pin)
 10PIN 2.5A(Per Pin) 14PIN 2.0A(Per Pin)
 16PIN 1.5A(Per Pin)
- Characteristics
 Waterproof level: IP68 (Mating)
 Operating temperature: -55°C ~ + 200°C
 Corrosion resistance: 144 H salt mist, 5 % salt solution, 35°C
 Humidity: 21 days at 95% RH
- Max Wire Size (AWG): #22 for 2&3pin
 #26 for 4&5pin
 #28 for 6&7&8pin
 #32 for 10&14&16pin

CABLE OD :4.1mm-4.5mm

RoHS Compliant

TOLERANCES ARE

MORETHANALL
 PCB CONNECTORS
 Cable ASSEMBLIES

煜倫股份有限公司

www.morethanall.com

DRAWING BY CY

CHECKED BY GENIUS

UNIT / mm

SCALE 1 : 1

DATE

SIZE A4

X, ±
 .X ± 0.50
 .XX ± 0.30
 .XXX ± 0.10
 ANG ± 2°

PPOJECTION

照片框

ORDER INFORMATION

PPM13-PA-xx-LF

SERIES | LEADFREE
 | 02~16 WAY
 | ASSEMBLY
 | MALE

DESCRIPTION: Snap Latch Metal 1KS Straight Plug

KEY ANGLES (RECEPTACLE FRONT VIEW):

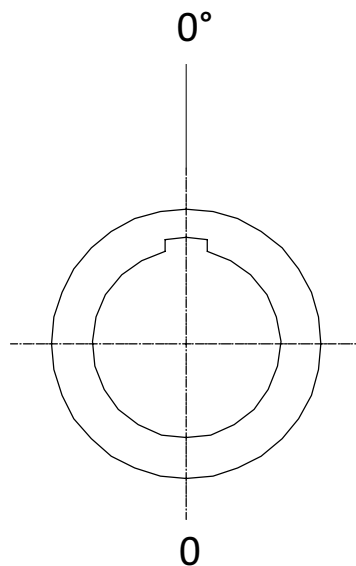

RoHS Compliant

TOLERANCES ARE

MORETHANALL
PCB CONNECTORS
Cable ASSEMBLIES

煜倫股份有限公司

www.morethanall.com

DRAWING BY CY

CHECKED BY GENIUS

UNIT / mm

SCALE 1:1

DATE

SIZE A4

X, ±
.X ± 0.50
.XX ± 0.30
.XXX ± 0.10
ANG ± 2°

PPOJECTION

照片框

ORDER INFORMATION

PPM13-PA-xx-LF

SERIES	LEADFREE
	02~16 WAY
	ASSEMBLY
	MALE

DESCRIPTION: Snap Latch Metal 1KS Straight Plug