

RoHS
Compliant

For Reference Only

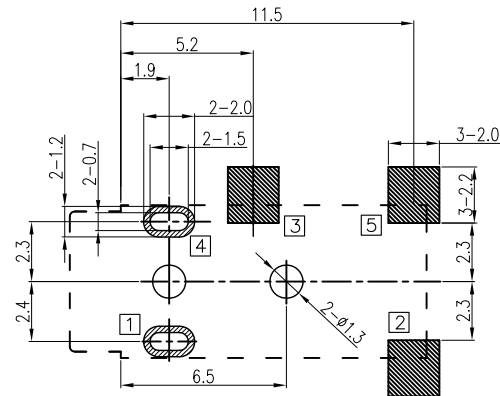
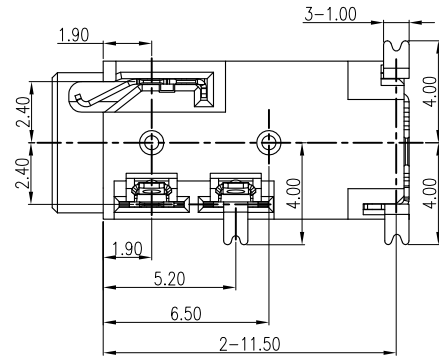
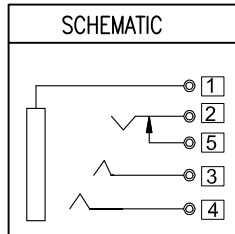
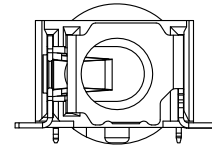
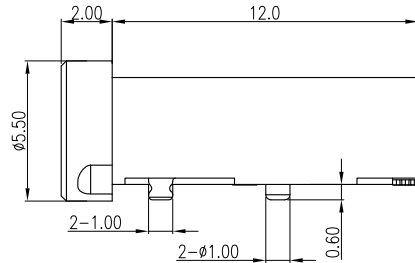
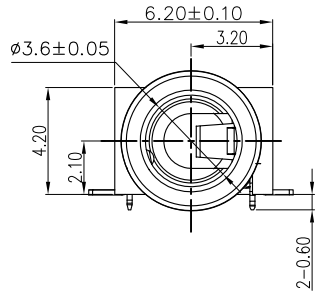

RECOMMENDED P.C.B LAYOUT
TOP VIEW (TOLERANCE: ±0.05)

SPECIFICATIONS

- INSERTION FORCE: INITIAL 0.3-3Kg, AFTER LIFE TEST 0.2-2Kg
WITHDRAWAL FORCE: INITIAL 0.3-3Kg, AFTER LIFE TEST 0.2-2Kg
- INSULATION RESISTANCE BETWEEN ANY ADJACENT TERMINALS SHALL NOT BE LESS THAN 100 MEGOHMS AT INITIAL AND 50 MEGOHM AT AFTER ENVIRONMENTA TEST BY 500 VOLTS MEGGER.
- JACK SHALL WITHSTAND 500 VOLTS BETWEEN ANY ADJACENT TERMINAL FOR ONE MINUTE.
- CONTACT RESISTANCE SHALL BE LESS THAN 50 MILLIOHMS AT INITIAL AND 100 MILLIOHMS AFTER LIFE TEST BETWEEN A TERMINAL OF THE SOCKET AND THAT OF THE MATING PLUG; LESS THAN 30 MILLIOHMS AT INITIAL AND 60 MILLIOHMS AFTER LIFE TEST BETWEEN TERMINAL OF THE SOCKET IN A CLOSED CIRCUITED, WHEN MEASURED AT A CURRENT OF LESS THAN 100 MILLIAMPERE 1 KHZ.
- LIFE: 5000 CYCLES
- MEASURING CONDITION:
TEMPERATURE: FROM 10°C TO 35°C.
RELATIVE HUMIDITY: FROM 45% TO 85% RH.
- ENVIRONMENTAL SPECIFICATIONS:
7.1 HUMIDITY TEST: HUMIDITY 90% TO 95% RH TEMPERATURE 40°C±2°C.
7.2 HEAT TEST: TEMPERATURE 85°C±2°C (HUMIDITY BELOW 50% RH).
7.3 COLD TEST: TEMPERATURE -40°C±2°C.
- PACKING: TAPE&REEL
- PRINTED DATE CODE "YYMMDD" ON TOP OF SOCKET
 - DD: DAY
 - MM: MONTH
 - YY: YEAR
- FOR LEAD FREE PROCESS.

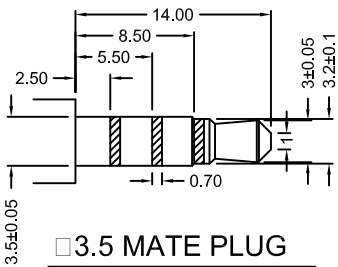

DESCRIPTION	MATERIAL	THK. (±0.1)	PLATING
TERMINAL 1	PHOSPHOR BRONZE	0.2	AG Plating
TERMINAL 2	PHOSPHOR BRONZE	0.2	
TERMINAL 3	PHOSPHOR BRONZE	0.2	
TERMINAL 4	PHOSPHOR BRONZE	0.2	
TERMINAL 5	BRASS	0.2	
HOUSING	HIGH TEMP. PLASTIC UL 94 V-0		COLOR: BLACK

RoHS Compliant

TOLERANCES ARE

MORETHANALL
PCB CONNECTORS
Cable ASSEMBLIES

煜倫股份有限公司

www.morethanall.com

DRAWING BY CY

CHECKED BY GENIUS

UNIT / mm

SCALE 1:1

DATE

SIZE A4

PPOJECTION

X, ±
.X ± 0.20
.XX ± 0.10
.XXX ± 0.05
ANG ±

照片框

ORDER INFORMATION

PJ-W14MR-05D-LF
 SERIES | REEL | METAL | LEADFREE
 5P4C
 POST 1.9+4.6mm
 90°SMT

DESCRIPTION: 3.5mm AUDIO JACK

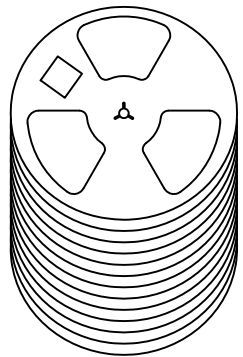

10盘 ↓

加防水袋

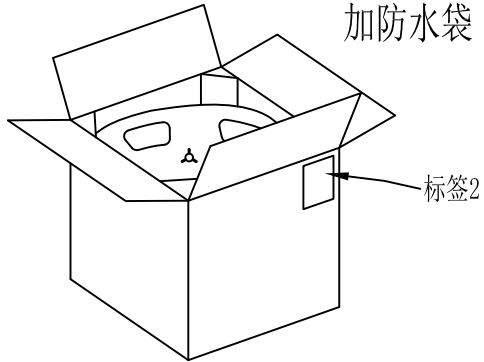

标签2

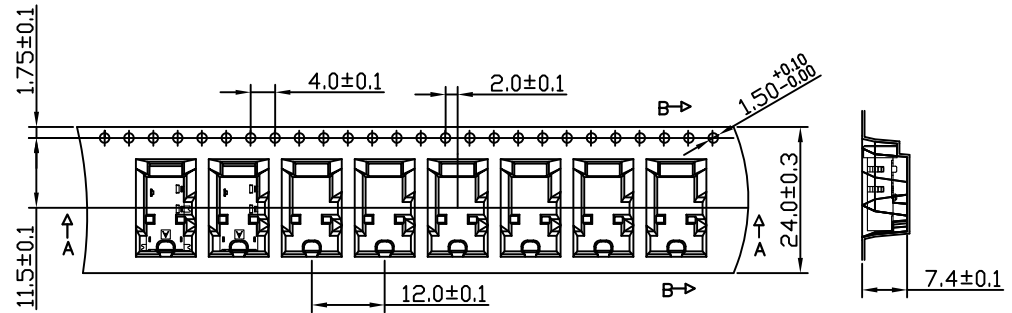

护角纸

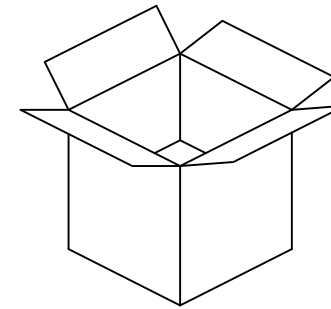
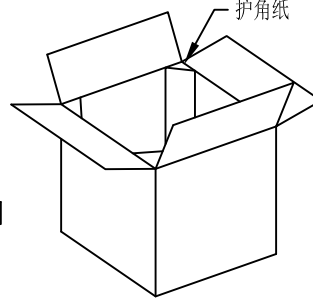

透明胶封箱

收料方向

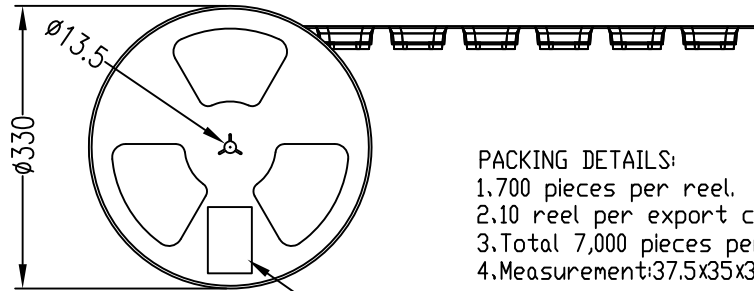

700pcs/盘

标签1

- PACKING DETAILS:
 1. 700 pieces per reel.
 2. 10 reel per export carton.
 3. Total 7,000 pieces per export carton.
 4. Measurement: 37.5x35x36.5cm(L x W x H)

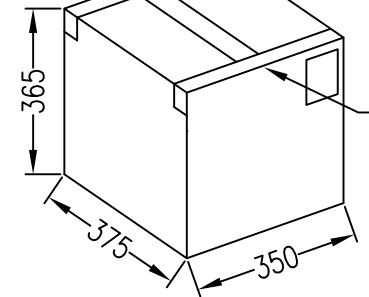

RoHS Compliant

TOLERANCES ARE

MORETHANALL
 PCB CONNECTORS
 Cable ASSEMBLIES

煜倫股份有限公司

www.morethanall.com

DRAWING BY CY

CHECKED BY GENIUS

UNIT / mm

SCALE 1 : 1

DATE

SIZE A4

X, ±
 .X ± 0.20
 .XX ± 0.10
 .XXX ± 0.05
 ANG ±

P PROJECTION

照片框

ORDER INFORMATION

PJ-W14MR-05D-LF
 SERIES REEL METAL POST 1.9+4.6mm 90°SMT
 LEADFREE 5P4C

DESCRIPTION: 3.5mm AUDIO JACK