

B-B Section

表面處理(Surface treatment):  
more than 40 μ"  
鍍金(Gold flash)

適用電線(Applicable wire):  
AWG# 24~28

線皮外徑(Insulation O.D):  
1.5~1.2 mm

材質(Material):  
磷青銅[Phosphor bronze]

包裝數量(Standard packing):  
10000 PCS

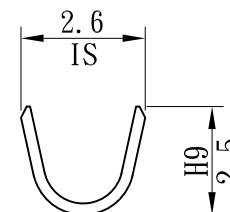
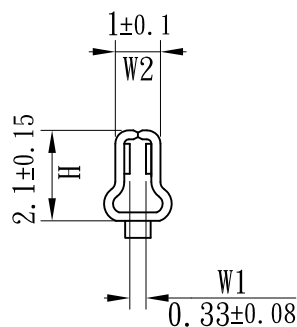
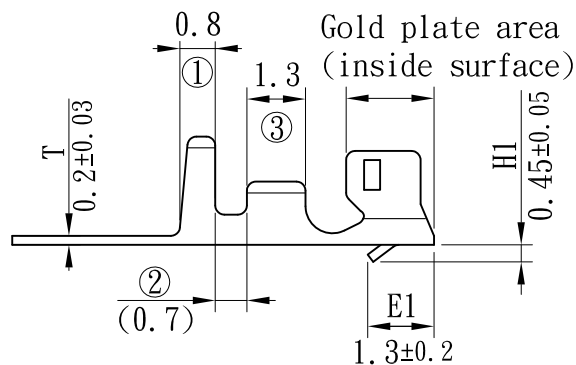

A-A Section

RoHS Compliant

TOLERANCES ARE

**MORETHANALL**  
PCB CONNECTORS  
Cable ASSEMBLIES

DRAWING BY CY

X.±

CHECKED BY GENIUS

.X±

UNIT / mm

SCALE 1:1

.XX±

DATE

.XXX±

ANG±

SIZE A4

PPOJECTION

照片框

ORDER INFORMATION

PH-TG-24-LF  
SERIES | LEADFREE  
24~28 AWG  
GOLD PLATED  
TERMINAL

煜倫股份有限公司

www.morethanall.com

DESCRIPTION: Terminal(2.0mm Pitch Series)