

PCB LAYOUT

PIN數	A	B	C	D
36	7.65	6.00	25.00	9.15
64	21.65	20.00	39.00	23.15
98	38.65	37.00	56.00	40.15
164	71.65	70.00	89.00	73.15

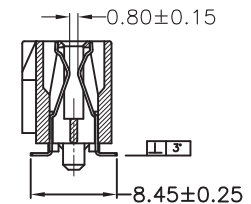
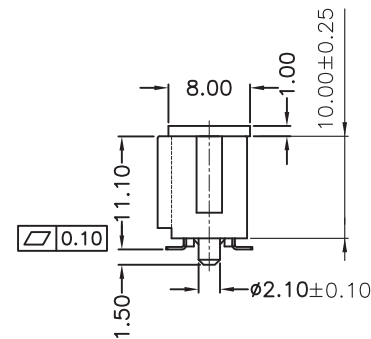

SECTION: A-A

Note:

- 1:Electical Performance
 - 1.1.Dielectric Withstanding Voltabge: 500V/AC For 1.0 Minute.
 - 1.2.Contadt Resistance:30mΩ Max
 - 1.3.Insulation Resistance:1000MΩ Min
- 2.Mechanical Performance.
 - 2.1.CONTACT INSERTION FORCE: 0.115Kg Max Per.Contact Pair.
 - 2.2.CONTACT WITHDRAWAL FORCE: 0.015Kg Min Per.Contact Pair.
 - 2.3.Terminol Retention Force (in housing): 0.5Kg Minper Terminal.
- 3.Material & Finish:
 - 3.1.Insulator:Hi-Temp NY-9T UL 94V-0,260"/10Sec, Black
 - 3.2.Contact Plating: Tin Plating At Solder Tail Area;
Gold Plating At Mating Area, All Over Nickel Plating.
- 4.Environmental:Operating Temperature: -55°C~+85°C

RoHS Compliant

TOLERANCES ARE

MORETHANALL
PCB CONNECTORS
Cable ASSEMBLIES

煜倫股份有限公司

www.morethanall.com

DRAWING BY CY

CHECKED BY GENIUS

UNIT / mm

SCALE 1 : 1

DATE

SIZE A4

X, ±
.X ± 0.20
.XX ± 0.10
.XXX ±
ANG ± 3°

PJECTION

照片框

ORDER INFORMATION

PCIX-VPC-xxx-LF

SERIES

LEADFREE

036:36WAY

164:164WAY

CAP
POST
180°SMT

DESCRIPTION: