

**NOTES:**

**\*Material**

Housing: Nylon46+30%G.F, UL 94V-0 Rated. Color: Black  
 Contact: Brass.  
 Plating: Gold plating over Nickel on contact Area; Tin plating on solder tail.

**\*Mechanical**

Insertion Force: 1.15N max per contact pair;  
 Withdrawal Force: 0.15N min per contact pair;  
 Contact Retention Force: 4.9N min per contact;

**\*Electrical Specification**

Contact Resistance : 30 Milliohms Max.  
 Current Resistance : 1.1 Ampere  
 Insulation Resistance : 1000 Megohms Min, At 500V AC.

**\*Environmental**

Operating Temperature : -55°C to +105°C

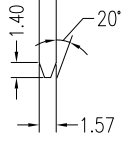
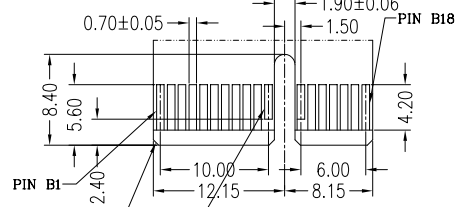

Primary (Component) Side

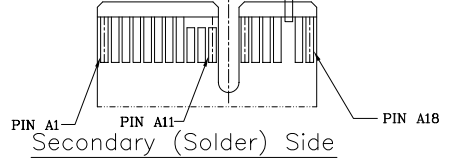

Secondary (Solder) Side

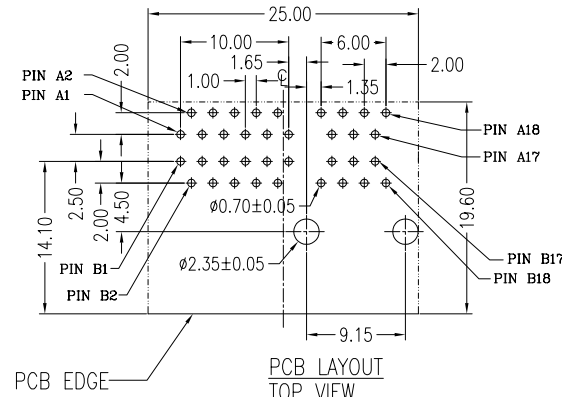

PCB LAYOUT TOP VIEW

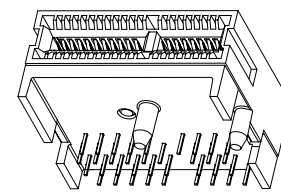

3D VIEW

**PCIX-L114-036-LF**  
**LEADFREE**  
**RoHS Compliant**



PART NO. PCIX-L114-036		CHECKED BY CY		TOLERANCES ARE .X ± 0.2 .XX ± .XXX ± AWG	DESCRIP TION: PCI Express R/A DIP Type Add Height 36P(left key) CRT
DWG NO. PCIX-L114-036		DRAWING BY			
FILE NO.		PROJECTION		AREA	REVISIONS
UNIT / mm	SCALE 1:1			HK	DATE

煜倫股份有限公司