

Note
1.Material:
 Contact—Copper Alloy
 Grounding Plate—Copper Alloy
 Housing— High Temp Thermoplastic
 LCP (UL 94V-0)
 Color:Black
2.Plating :
 Underplate : 30u”(0.76um) Nickel
 Solder Tails : 100u”(2.54um)Tin without Lead
3.Electrical
 Current Rating : 0.5A
 Insulation Resistance : >1x10⁹ ohm at 500 Vdc
 >1x10⁸ ohm at 500 Vdc
 after Enviromental Conditioning
 Withstanding Voltage : 500 Vrms at Sea Level
4.Enviromental
 Temperature Rating : -10°c to +70°c

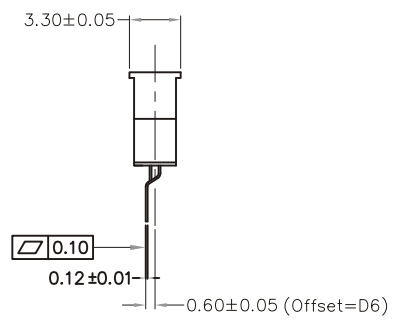
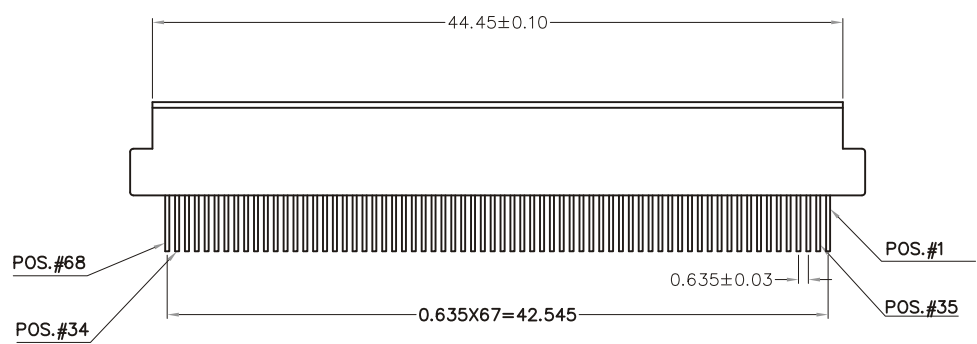

PCC-SWA06-68-LF
 LEADFREE
 RoHS Compliant

 焯倫股份有限公司	PART NO. PCC-SWA06-68		CHECKED BY CY	TOLERANCES ARE .X ± .XX ± .XXX ± AWG	DESCRIP TION:			
	DWG NO. PCC-SWA06-68							
UNIT / mm	SCALE 1:1	PROJECTION	AREA	REVISIONS	HK	DATE		