

MATERIAL

Contact Pin : Brass

SPECIFICATION

Current Rate : 1 AMP
 Insulation Resistance : 5000MΩMin. at DC 500V
 Contact Resistance : 20mΩMax. at DC 100mA
 Dielectric Voltage : AC 500V for one minute
 Operation Temperature : -40°C to + 105°C

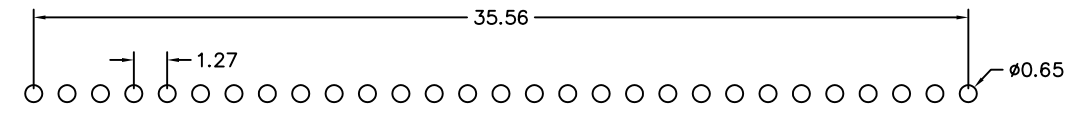
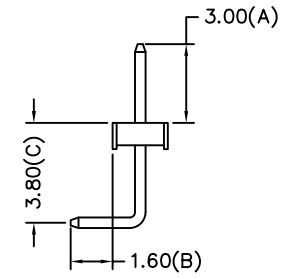
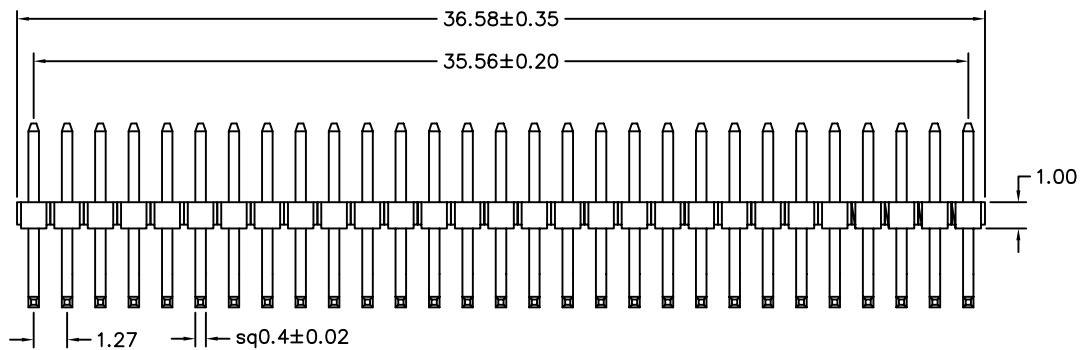

Recommended P.C.B Layout

PA-R103016-1X29-LF
 LEADFREE

RoHS Compliant



煜倫股份有限公司

PART NO. PA-R103 016-1X29		CHECKED BY CY	TOLERANCES ARE .X ± 0.2 .XX ± .XXX ± AWG	DESCRIPTION: PIN HEADER 1.27*1.27mm RIGHT ANGLE TYPE, SINGLE ROW	AREA	REVISIONS	HK	DATE
DWG NO. PA-R103 016-1X29								
FILE NO.		PROJECTION						
UNIT / mm	SCALE 1:1							