

MATERIAL

Insulator : NYLON 46
Contact Pin : Brass

SPECIFICATION

Current Rate : 1 AMP
Insulation Resistance : 5000MΩMin. at DC 500V
Contact Resistance : 20mΩMax. at DC 100mA
Dielectric Voltage : AC 500V for one minute
Operation Temperature : -40°C to + 105°C

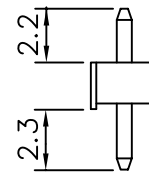
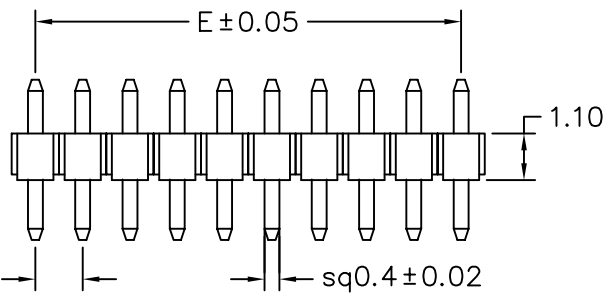

- 1: Single row
Plastic Height=1.5mm
2. No. of contacts per row
3. G: Gold flash
T: Tin plated
4. B: Black Insulator
W: White Insulator
5. Pinrex internal code.

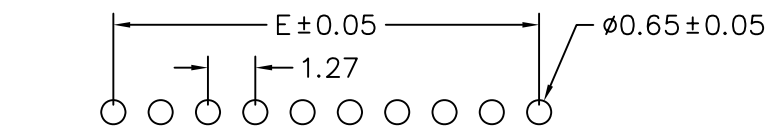

Recommended P.C.B Layout

PA-D11-1Xxx-LF
LEADFREE
RoHS Compliant

POLES	DIM E	POLES	DIM E
		18	21.59
2	1.27	19	22.86
3	2.54	20	24.13
4	3.81	21	25.40
5	5.08	22	26.67
6	6.35	23	27.94
7	7.62	24	29.21
8	8.89	25	30.48
9	10.16	26	31.75
10	11.43	27	33.02
11	12.70	28	34.29
12	13.97	29	35.56
13	15.24	30	36.83
14	16.51	31	38.10
15	17.78	32	39.37
16	19.05	33	40.64
17	20.32		



PART NO. PA-D11-1Xxx

DWG NO. PA-D11-1Xxx

FILE NO.

APPROVED BY CY

DRAWING BY

UNIT / mm

SCALE 1:1

PROJECTION

TOLERANCES ARE
.0 =±.30
.00 =±.15
.000 =±.XXX
.0000=±.
ANG.=±3°

DESCRIPTION:
AREA

PIN HEADER 1.27*1.27mm
STRAIGHT TYPE, SINGLE ROW
REVISIONS
HK
DATE

焯倫股份有限公司