

0.80*No.of Contacts-0.80±0.10

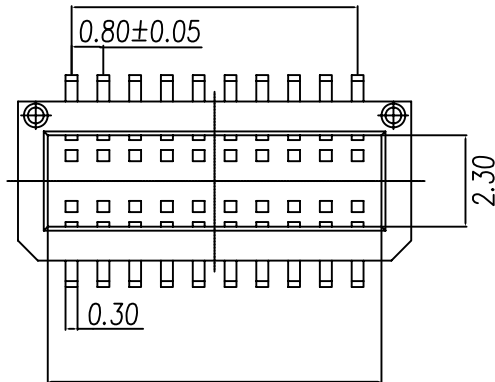

0.40+0.80*No.of Positions±0.05

F/M ASSEM HEIGHT	PART NO.	L
4.00H	NPE-P29P-xxx	2.90
4.50H		
5.00H		
5.50H	NPE-P34P-xxx	3.40
6.00H		
6.50H	NPE-P39P-xxx	3.90
7.00H		

Specifications

Current Rating: 0.5Amp
 Insulation Resistance: 1000MΩ Min.
 Dielectric Withstanding: 300V AC/DC
 Contact Resistance: 20mΩ Max.
 Operating Temperature:-40°C to +105°C

Materials

Contact Material: Phosphor Bronze
 Insulation Material: Polyester, UL 94V-0
 Nylon-9T

NPE-PxxP-xxx-LF
 LEADFREE

RoHS Compliant

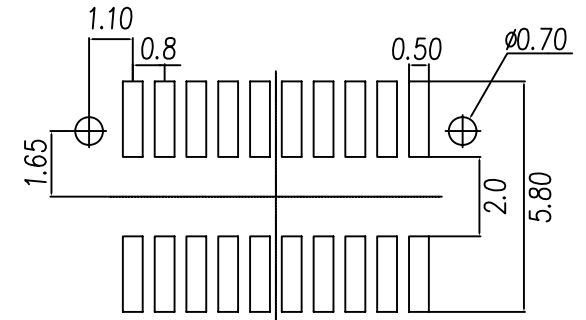
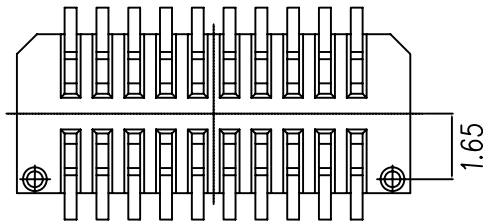
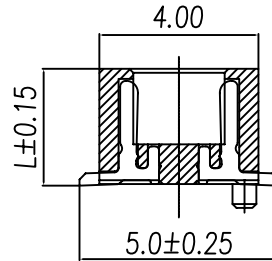
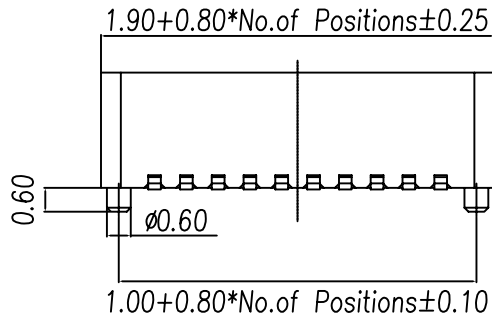

RECOMMENDED P.C.BOARD LAYOUT

MORE THAN ALL
 CONNECTORS
 ASSEMBLIES

PART NO. NPE-PxxP-xxx

DWG NO. NPE-PxxP-xxx

FILE NO.

CHECKED BY CY

DRAWING BY

TOLERANCES ARE

.X ± 0.38
 .XX ± 0.25
 .XXX ± 0.13
 AWG

DESCRIPTION: 0.8mm BOARD TO BOARD MALE

焜倫股份有限公司

UNIT / mm

SCALE 1:1

PROJECTION



AREA

REVISIONS

HK

DATE