

Specifications

- Current rating : 0.5A AC/DC
- Voltage rating : 150V AC/DC
- Contact resistance : 40m ohm. max.
- Insulation resistance : 1000M ohm. min.at 100V DC
- Withstanding Voltage : 650V AC for one minute
- Operating Temperature range : -55°C to +85°C
- Material and Plating
- Insulator :High Temp. Plastic (PPS UL94V-0)
- Insulator Color:Coffee
- Contact :Phosphor Bronze
- Metal Tab:Copper Alloy
- Plating : Selective Gold Plated

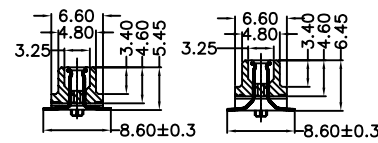
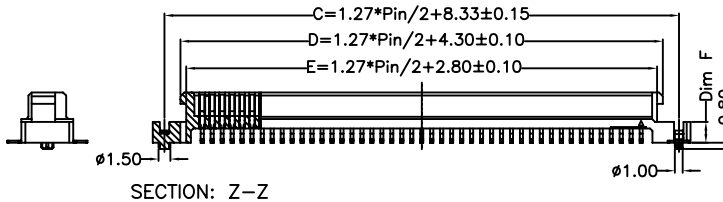
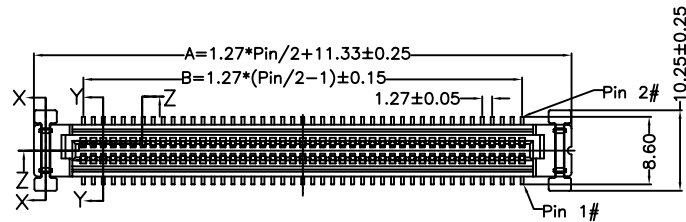

5.4mm Height 6.4mm Height

SECTION: Y-Y

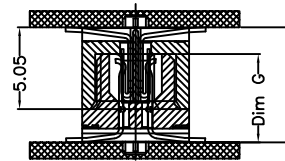

Mating Draw (Ref)

**Mating Dimension :

P/N(Socket)	P/N(Plug)	Socket Height Dim G	Mating Height Dim H	Dim F
NP13-S20x-xxx	NP13-P51x-xxx	5.40	7.10	1.7
NP13-S30x-xxx	NP13-P51x-xxx	6.40	8.10	2.7

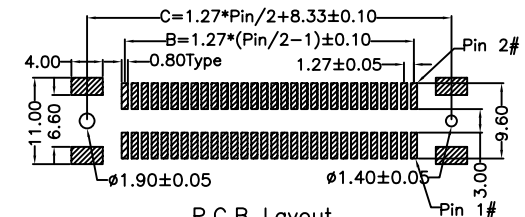

P.C.B Layout
(Component Side View)

Dimension:

No.of Contacts	A	B	C	D	E
20	24.03	11.43	21.03	17.00	15.50
30	30.38	17.78	27.38	23.35	21.85
40	36.73	24.13	33.73	29.70	28.20
50	43.08	30.48	40.08	36.05	34.55
60	49.43	36.83	46.43	42.40	40.90
80	62.13	49.53	59.13	55.10	53.60
100	74.83	62.23	71.83	67.80	66.30
120	87.53	74.93	84.53	80.50	79.00

RoHS Compliant

TOLERANCES ARE

MORETHANALL
PCB CONNECTORS
Cable ASSEMBLIES
煜倫股份有限公司
www.morethanall.com

DRAWING BY CY
CHECKED BY GENIUS
UNIT / mm SCALE 1 : 1
DATE
SIZE A4 PPROJECTION

- X, ±
- .X ±
- .XX ±
- .XXX ±
- ANG ±

照片框

ORDER INFORMATION

NP12715-Sxxx-xxx-LF

SERIES | LEADFREE
020-120WAY
A:W/EAR+POST
P:W/POST
FEMALE X:NON/EAR+POST
20:UNMATED HIGH 2.0mm
30:UNMATED HIGH 3.0mm

DESCRIPTION: 1.27mm Board to Board Socket