

Dim.E= 2.0mm (Circuits:10~80pin)  
 DIM.E= 3.0mm (Circuits:10~60pin)

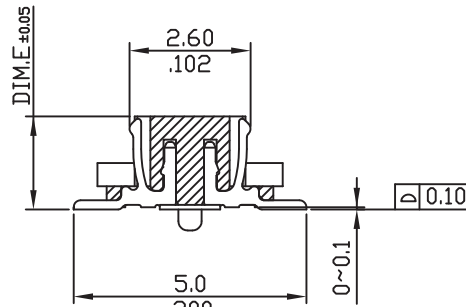
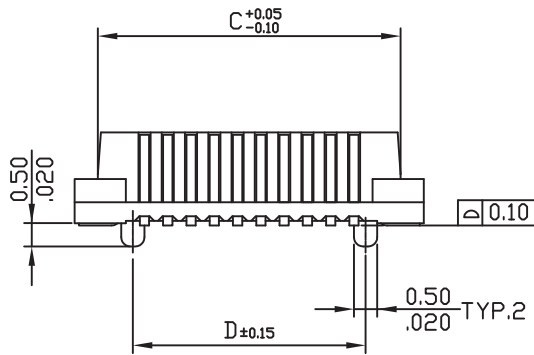

A-A SEC

DIM.A = 0.50 \* No. of Spaces  
 DIM.B = DIM.A + 3.0  
 DIM.C = DIM.A + 2.0  
 DIM.D = DIM.A + 0.5  
 \* Available in 10 through 80 circuits

- Material:
- \* Insulation: Glass filled Polyamide UL 94V-0  
Color Black
  - \* Contact: Copper alloy, t=0.2mm
  - \* Fixed Tab: Brass, t=0.2mm
  - \* Plating code: Gold flash over Nickel

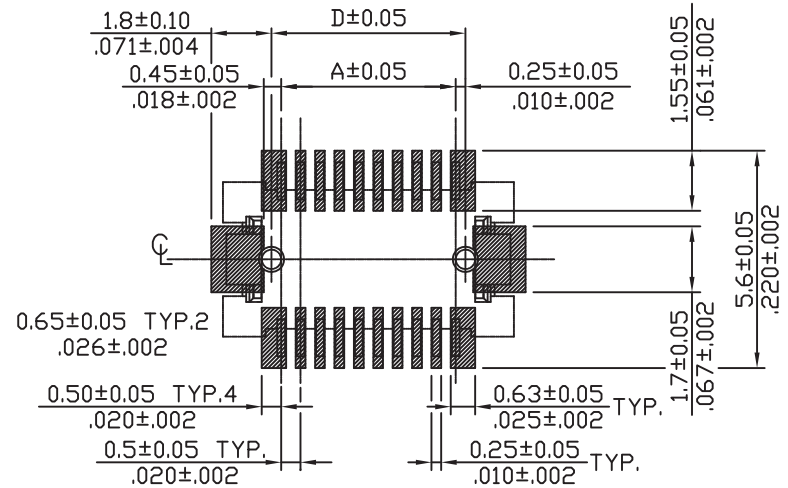

Recommended P.C. Board Layout

RoHS Compliant

TOLERANCES ARE

**MORETHANALL**  
 PCB CONNECTORS  
 Cable ASSEMBLIES

煜倫股份有限公司

www.morethanall.com

DRAWING BY CY

CHECKED BY GENIUS

UNIT / mm

SCALE 1:1

DATE

SIZE A4

X. ±  
 .X ± 0.20  
 .XX ± 0.10  
 .XXX ± 0.05  
 ANG ±

PPOJECTION



照片框

ORDER INFORMATION

NP0526-SxxA-xxx-LF

SERIES | LEADFREE  
 | 010~080WAY  
 | POST+EAR  
 | UNMATED HIGH  
 | FEMALE

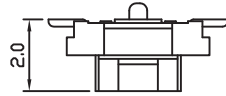
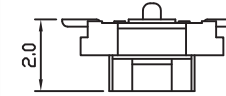
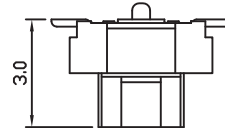
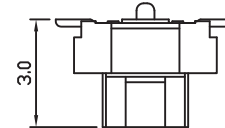
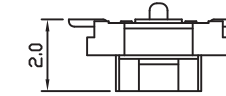
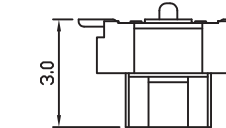
DESCRIPTION:

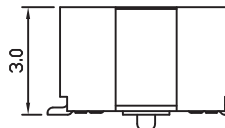
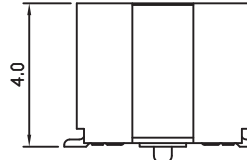
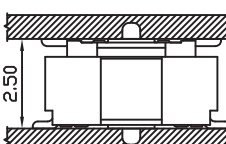
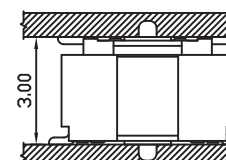
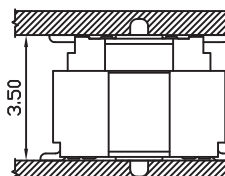
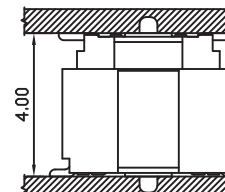
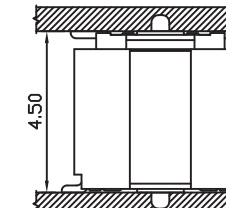
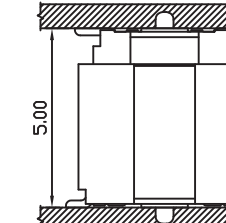
Female	NP0526-S05A-xxx 	NP0526-S05A-xxx 	Circuits:10~60 PIN NP0526-S10A-xxx 	Circuits:10~60 PIN NP0526-S10A-xxx 	NP0526-S05A-xxx 	Circuits:10~60 PIN NP0526-S10A-xxx 
Male	NP0526-P20A-xxx 	NP0526-P25A-xxx 		NP0526-P30A-xxx 	NP0526-P40A-xxx 	
Mating Height						

RoHS Compliant

TOLERANCES ARE

**MORETHANALL**  
PCB CONNECTORS  
Cable ASSEMBLIES

煜倫股份有限公司

www.morethanall.com

DRAWING BY CY

CHECKED BY GENIUS

UNIT/mm SCALE 1:1

DATE

SIZE A4

X, ±  
.X ± 0.20  
.XX ± 0.10  
.XXX ± 0.50  
ANG ±

PROJECTION 

照片框

ORDER INFORMATION

NP0526-SxxA-xxx-LF

SERIES

LEADFREE

010~080WAY

POST+EAR

UNMATED HIGH

FEMALE

DESCRIPTION: 0.50mm(.002") Board To Board Receptacle Connector