

CIRCUITS	DIM A	DIM B	DIM C	DIM D	W/O Locating peg	With Locating peg
6	1.00	3.50	2.70	2.50	⊕	
10	2.00	4.50	3.70	3.50	⊕	⊕
12	2.50	5.00	4.20	4.00		
14	3.00	5.50	4.70	4.50		
16	3.50	6.00	5.20	5.00		
18	4.00	6.50	5.70	5.50		
20	4.50	7.00	6.20	6.00	⊕	⊕
22	5.00	7.50	6.70	6.50		
24	5.50	8.00	7.20	7.00	⊕	⊕
26	6.00	8.50	7.70	7.50		
28	6.50	9.00	8.20	8.00	⊕	
30	7.00	9.50	8.70	8.50	⊕	
32	7.50	10.00	9.20	9.00		
34	8.00	10.50	9.70	9.50	⊕	
36	8.50	11.00	10.20	10.00		
38	9.00	11.50	10.70	10.50		
40	9.50	12.00	11.20	11.00	⊕	⊕
42	10.00	12.50	11.70	11.50		
44	10.50	13.00	12.20	12.00		
46	11.00	13.50	12.70	12.50		
48	11.50	14.00	13.20	13.00		
50	12.00	14.50	13.70	13.50	⊕	
52	12.50	15.00	14.20	14.00		
54	13.00	15.50	14.70	14.50		
56	13.50	16.00	15.20	15.00		
58	14.00	16.50	15.70	15.50		
60	14.50	17.00	16.20	16.00	⊕	
70	17.00	19.50	18.70	18.50		
80	19.50	22.00	21.20	21.00		
A0(100)	24.50	27.00	26.20	26.00	⊕	

Diagram	Molding description
○	mass production & assemble mold
⊙	sample & assemble mold
⊕	mass production & fix mold
⊕	sample & fix mold

PIN數	FILM(E)
6PIN	3.0X5.2
18PIN(含)以下	∅4.0
18PIN以上	6.0X5.2

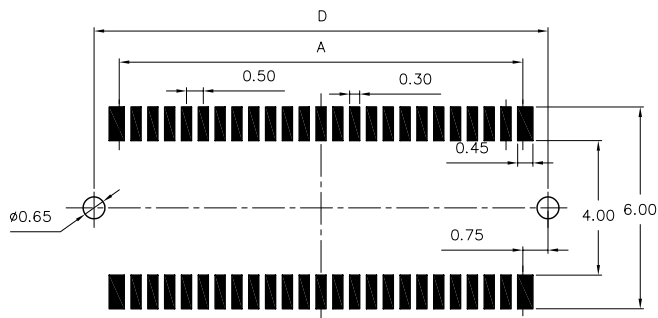

Recommended PCB Layout  
(PCB TOLERANCE ±0.05)

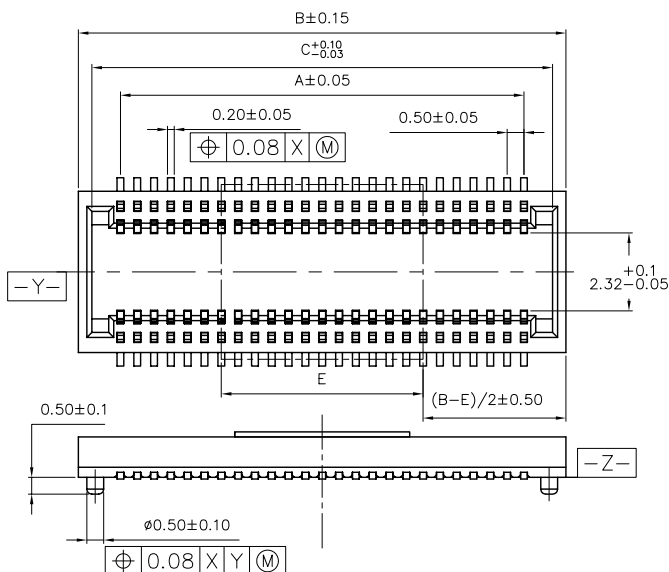
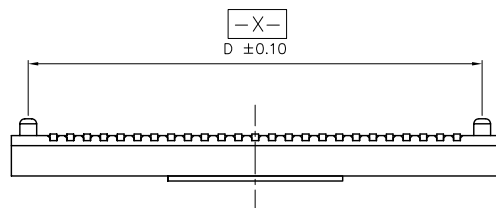

NOTES: (UNLESS OTHERWISE SPECIFIED)

1. CURRENT RATING: 0.3 AMPERE.
2. CONTACT RESISTANCE: 60 m ohms MAX. FOR INITIAL.
3. DIELECTRIC WITHSTANDING: AC 50V
4. INSULATION RESISTANCE: 100 M ohms MIN..
5. HARMFUL MATERIAL SHOULD BE COMPLIANT TO DOC. "EI-0005" STANDARDS.

NP0525-S13PC-xxx-LF  
LEADFREE

RoHS Compliant

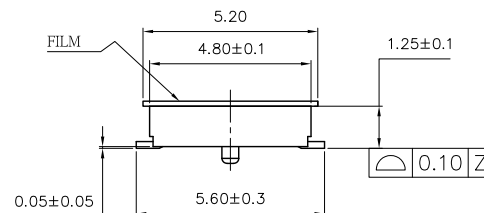

**MORETHANALL**  
CONNECTORS  
ASSEMBLIES

煜倫股份有限公司

PART NO. NP0525-S13PC-xxx		CHECKED BY CY		TOLERANCES ARE .X ± 0.2 .XX ± .XXX ± AWG	DESCRIP TION: CUSTOMER DRAWING 0.5mm Board To Board Socket Series
DWG NO. NP0525-S13PC-xxx		DRAWING BY			
FILE NO.		PROJECTION		AREA	REVISIONS
UNIT / mm	SCALE 1:1			HK	DATE