

Specifications:
 Current Rating: 0.3A AC,DC
 Voltage Rating: 30V AC,DC
 Contact Resistance: 90m ohm.Max
 Insulation Resistance: 50M ohm.Min
 Withstanding Voltage: 100V AC/Minute
 Operating Temperature Range: -35°C~+85°C

Material:
 Insulator: LCP(UL94V-0)
 Insulator Color: Black
 Contact: Phosphor bronze
 Plated: Gold

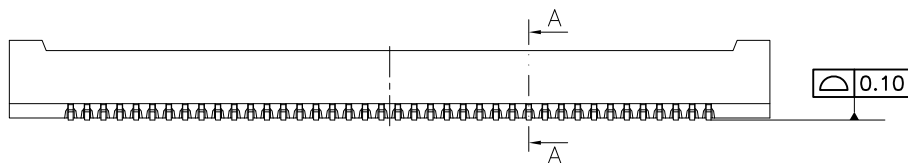
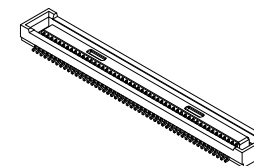

Dimension Information:

Pin.No	Dim.A	Dim.B
10	4.60	1.60
20	6.60	3.60
30	8.60	5.60
40	10.60	7.60
50	12.60	9.60
60	14.60	11.60

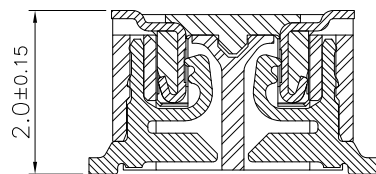

Matting drawing

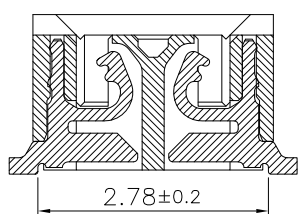

A-A cross section
Scale : X2

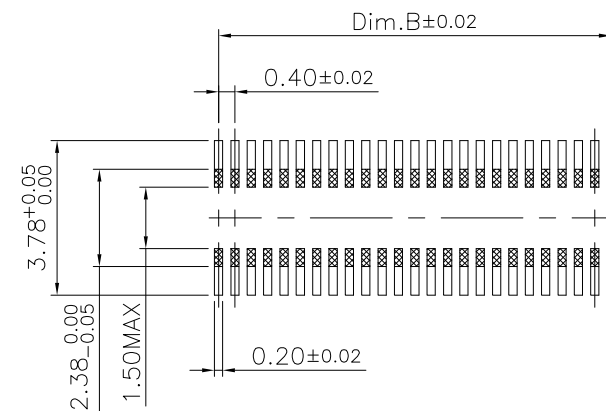

P.C.B Layout

RoHS Compliant

TOLERANCES ARE

MORETHANALL
 PCB CONNECTORS
 Cable ASSEMBLIES

煜倫股份有限公司

www.morethanall.com

DRAWING BY CY

CHECKED BY GENIUS

UNIT / mm SCALE 1 : 1

DATE

SIZE A4

X, ±
 .X ± 0.20
 .XX ± 0.15
 .XXX ±
 ANG ±

PPOJECTION

照片框

ORDER INFORMATION

NP04185-S19X-xxx-LF

SERIES | LEADFREE
 | 010-060WAY
 | NON POST
 | UNMATED HIGH 1.9mm
 | FEMALE

DESCRIPTION: 0.4mm BOARD TO BOARD MATED HEIGHT 2.0mm SOCKET CONNECTOR