

MATERIAL
Contact Pin : Brass

SPECIFICATION

Current Rate : 1 AMP
Insulation Resistance : 5000MΩMin. at DC 500V
Contact Resistance : 20mΩMax. at DC 100mA
Dielectric Voltage : AC 500V for one minute

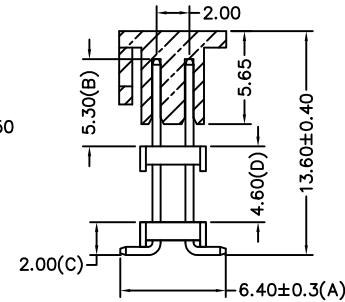
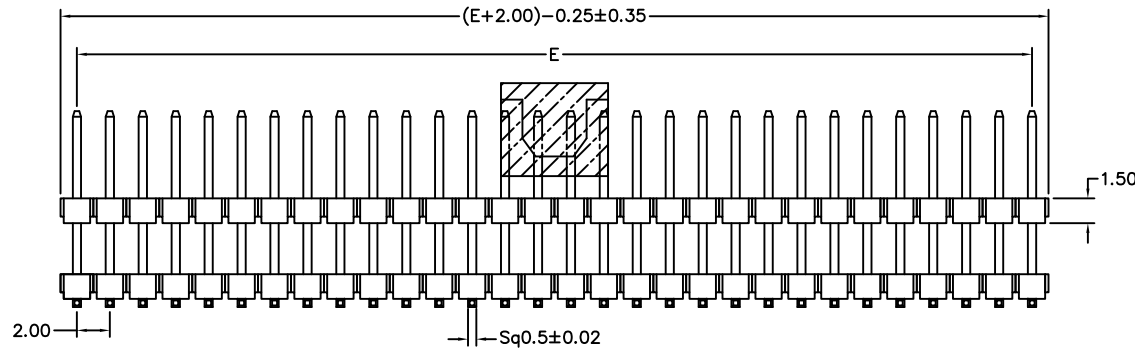

POLES	DIM E	POLES	DIM E
		23	44.00
2	2.00	24	46.00
3	4.00	25	48.00
4	6.00	26	50.00
5	8.00	27	52.00
6	10.00	28	54.00
7	12.00	29	56.00
8	14.00	30	58.00
9	16.00	31	60.00
10	18.00	32	62.00
11	20.00	33	64.00
12	22.00	34	66.00
13	24.00	35	68.00
14	26.00	36	70.00
15	28.00	37	72.00
16	30.00	38	74.00
17	32.00	39	76.00
18	34.00	40	78.00
19	36.00	41	80.00
20	38.00	42	82.00
21	40.00	43	84.00
22	42.00	44	86.00

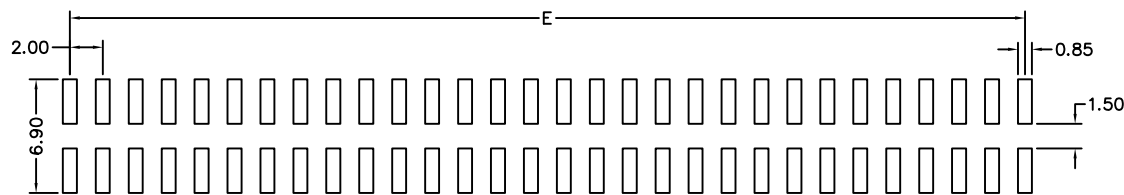

Recommended P.C.B Layout

RoHS Compliant

TOLERANCES ARE

MORETHANALL
PCB CONNECTORS
Cable ASSEMBLIES

DRAWING BY CY

X, ±

CHECKED BY GENIUS

.X ± 0.30

UNIT / mm

SCALE 1 : 1

.XX ± 0.20

DATE

.XXX ±

ANG ± 3°

SIZE A4

P PROJECTION

照片框

ORDER INFORMATION

MS-V066X53C-2Xxx-LF

SERIES | LEADFREE
180°SMT | 2X02:04WAY
HIGH 6.6mm | 2X44:88WAY
CONTACT 5.3mm
NON POST

DESCRIPTION:

煜倫股份有限公司

www.morethanall.com