

NOTES:

1. ELECTRICAL CHARACTERISTICS:
 - 1.1. CONTACT CURRENT RATING: 0.5 AMPERE MAX. PER PIN.
(PER PIN) DOESN'T EXCEED 30°C ABOVE AMBIENT AT 0.5 AMPERE MAX. PER PIN.
 - 1.2. VOLTAGE RATING: 50V AC.
 - 1.3. INSULATION RESISTANCE: 500 MEGAOHMS MIN. AT 500V DC.
 - 1.4. DIELECTRIC WITHSTANDING VOLTAGE: 300V AC RMS AT 60Hz, FOR 1 MINUTE.
 - 1.5. CONTACT RESISTANCE : 55 MILLIOHMS MAX. PER PIN INITIAL.
 $\Delta R=20$ MILLIOHMS MAX. PER PIN AFTER FULL ENVIRONMENTAL TESTING.
2. MECHANICAL CHARACTERISTICS: DURABILITY: 50 MATING CYCLES.
3. OPERATION TEMPERATURE: -40°C TO +80°C.
4. PLEASE CONTACT FOXCONN SALES REPRESENTATIVE TO VERIFY PRODUCT DETAIL & AVAILABILITY.

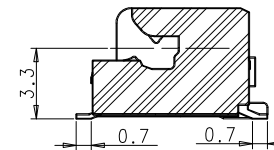
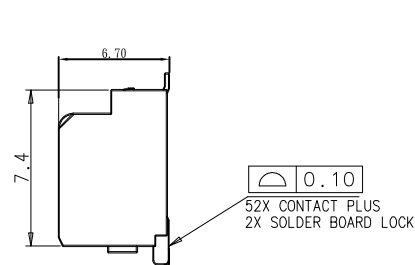

SECTION A-A

RoHS Compliant

TOLERANCES ARE

MORETHANALL
PCB CONNECTORS
Cable ASSEMBLIES

DRAWING BY CY

CHECKED BY GENIUS

UNIT / mm

SCALE 1 : 1

DATE

SIZE A4

X, ±
.X ± 0.25
.XX ± 0.15
.XXX ± 0.05
ANG ±

P PROJECTION

照片框

ORDER INFORMATION

MPCI-W67PX-052-LF
SERIES | | LEADFREE
| | 52 WAY
| | NON POST
| | HIGH 6.7mm
| | 90°SMT

DESCRIPTION: MINI PCI-E CARD CONNECTOR H=6.70

煜倫股份有限公司

www.morethanall.com