

## Features:

- Material: Phosphor bronze
- Wire range: #20 ~ #30 AWG
- Thickness: 0.2mm

## Specifications:

- Current rating:

Wire size	# 20	# 22	# 24	# 26	# 28	# 30
Ampere	5 A	5 A	4 A	3 A	2 A	1 A

- Voltage rating: 250V AC(RMS) or DC
- Contact resistance: 10mΩ max.
- Dielectric strength: 1500V AC/minute
- Temperature rise: 30°C max.

(carry rated current load)

## Ordering Information

Part No.	Finished	Wire size	Dim. a	Dim. b	Dim. c	Dim. d
MIF-MT-26	Tin-plated	#26 ~ #30 AWG	1.8	1.6	2.4	1.9
MIF-MT-20	Tin-plated	#20 ~ #24 AWG	2.1	2.1	2.7	2.4

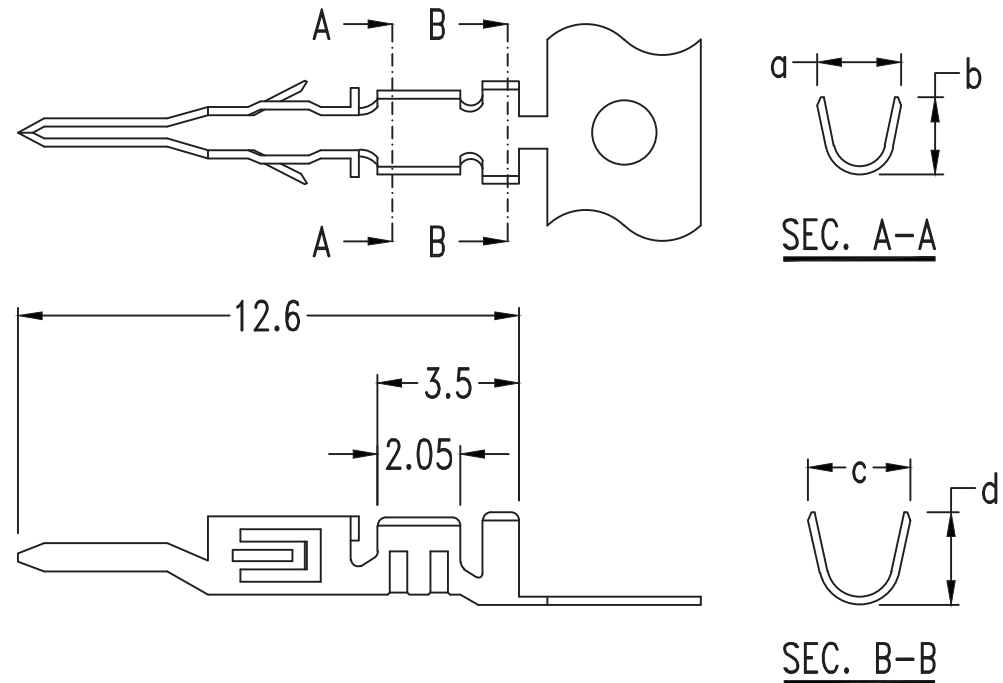

**MORETHANALL**  
PCB CONNECTORS  
Cable ASSEMBLIES  
煜倫股份有限公司

www.morethanall.com

RoHS Compliant

DRAWING BY CY

CHECKED BY GENIUS

UNIT / mm SCALE 1 : 1

DATE

SIZE A4

TOLERANCES ARE

X. ±  
.X ± 0.25  
.XX ± 0.15  
.XXX ± 0.05  
ANG ±

PJECTION

照片框

ORDER INFORMATION

MIF-MT-xx-LF  
SERIES | T LEADFREE  
26:26~30 AWG  
20:20~24 AWG  
TERMINAL  
MALE

DESCRIPTION: .118"(3.00mm) Crimp Terminal