

PCB Layout
(Top View)

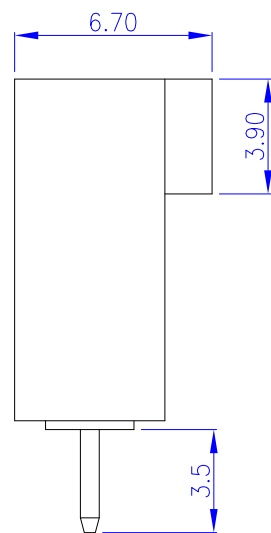
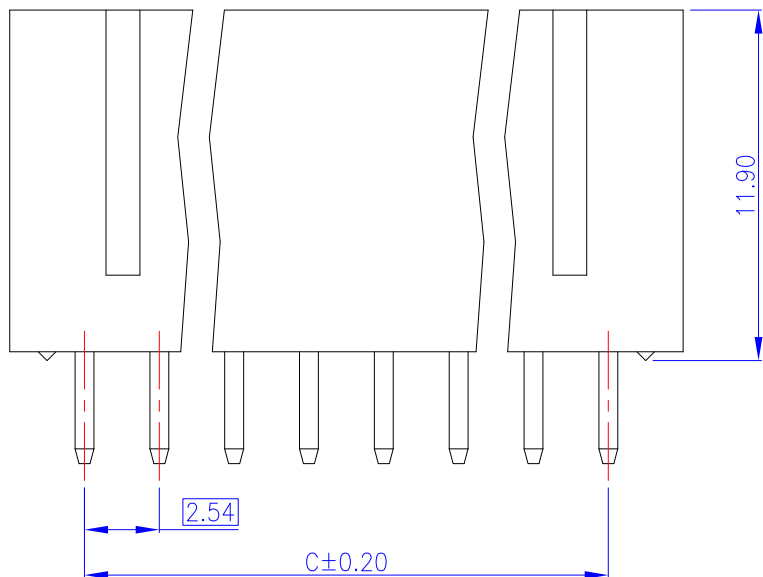

Material and Finish

1. Housing: PBT (UL94V-0), Black.
2. Terminal: Sq 0.64mm Brass, Gold Plating.

Electrical Characteristics

1. Current Rating: 3.0 Amp. Max..
2. Dielectric Withstand Voltage:
1000V AC RMS for 60Seconds.
3. Insulation Resistance:
1000M Ohms Min. at 1000V DC.

Mechanical Characteristics

1. Operating Temperature: -55°C ~ +105°C

Dimensions			
Pos.	A	B	C
02	7.62	5.58	2.54
03	10.16	8.12	5.08
04	12.70	10.66	7.62
05	15.24	13.20	10.16
06	17.78	15.74	12.70
07	20.32	18.28	15.24
08	22.86	20.82	17.78
09	25.40	23.36	20.32
10	27.94	25.90	22.86
11	30.48	28.44	25.40
12	33.02	30.98	27.94
13	35.56	33.52	30.48
14	38.10	36.06	33.02
15	40.64	38.60	35.56
16	43.18	41.14	38.10
17	45.72	43.68	40.64
18	48.26	46.22	43.18

RoHS Compliant

TOLERANCES ARE

MORETHANALL
PCB CONNECTORS
Cable ASSEMBLIES

DRAWING BY CY

CHECKED BY GENIUS

UNIT / mm

SCALE 1 : 1

DATE

SIZE A4

X, ±
.X ± 0.30
.XX ± 0.20
.XXX ± 0.10
ANG ±

PJECTION

照片框

ORDER INFORMATION

MCG-D-1Xxx-LF
SERIES | LEADFREE
1X02:02WAY
1X18:18WAY
DIP 180°

煜倫股份有限公司

www.morethanall.com

DESCRIPTION: