

WATERPROOF RATE: IP68.

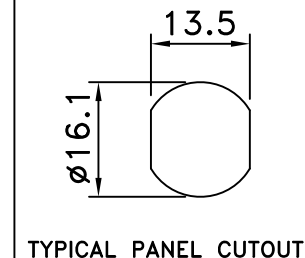
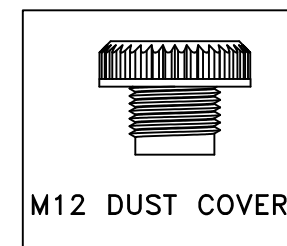
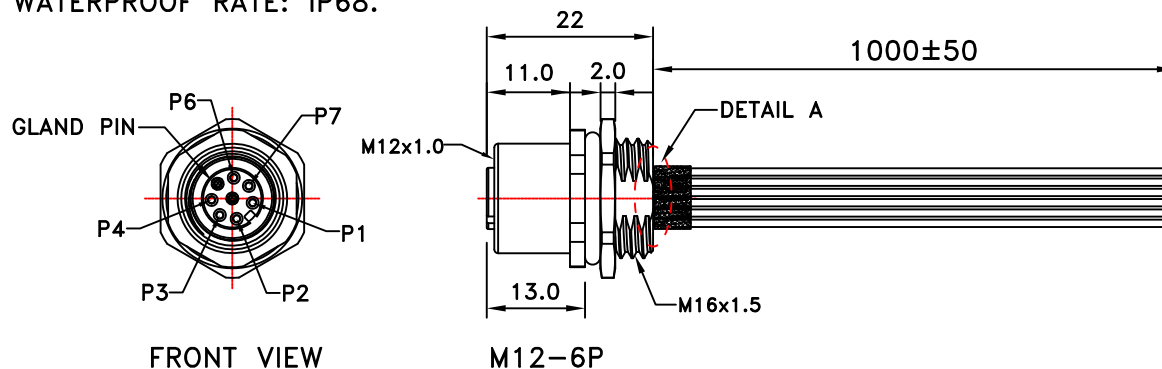

***CONSTRUCTION:

- 1.HOOK-UP WIRE: * UL1061 22AWG*1C OD:1.3mm
COLOR: RED,BLACK,WHITE,BLUE,GREY,YELLOW.

***CONNECTORS:

- 2.M12-6F: * M12 6PIN FEMALE REAR MOUNT SOLDER TYPE.
* PINS: BRASS WITH GOLD PLATED.
* GLAND PIN: BLACK PLASTIC.
* INSULATOR: NYLON BLACK 66 UL 94V-0 RATED.
* METAL BODY: COPPER ALLOY WITH NICKEL PLATED.
* O-RING: SILICONE RUBBER BLACK & RED COLOR.
* NUT: M16, BRASS WITH NICKEL PLATED.
* EPOXY BLACK COLOR.
- 3.GLUE: * TUBE: BLACK SHRINKLE TUBE.
- 4.TUBE: * CT:2 Ohm IS:20M ohm DC300V 0.1S.
- 5.TEST: * CURRENT RATING: 2A VOLTAGE RATING: 125V.
- 6.ELECTRICAL: * PACK EACH CABLE IN A POLY BAG.
- 7.PACKING: * MATERIAL WITH RoHS GRADE.
- 8.MATERIAL:

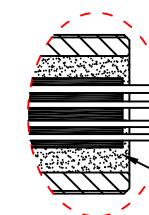

GLUE:EPOXY BLACK

DETAIL A

PIN OUT

M12-6F

1	RED	NC
2	BLACK	NC
3	WHITE	NC
4	BLUE	NC
6	GREY	NC
7	YELLOW	NC

RoHS Compliant

TOLERANCES ARE

MORETHANALL
PCB CONNECTORS
Cable ASSEMBLIES

煜倫股份有限公司

www.morethanall.com

DRAWING BY CY

CHECKED BY GENIUS

UNIT / mm

SCALE 1 : 1

DATE

SIZE A4

PPOJECTION

X, ±
.X ±
.XX ±
.XXX ±
ANG ±

照片框

ORDER INFORMATION

M12X1-060022W1PANO-F1M-LF

SERIES

06 WAY
22 AWG

WIRE

PANEL FRONT

NUT+O-RING

FEMALE

1000mm

LEADFREE

DESCRIPTION: M12-6PIN FEMALE REAR MOUNT WITH CABLE 1M