

Notes:

1. Material:

Insulation: Nylon 6 UL 94V-2

Contact: Brass



2. Glow wire requirement:

IEC 60695-2-12 GWFI 960°C@0.38mm & 930°C@0.75mm

& 960°C@1.50mm & 960°C@3.00mm

IEC 60695-2-11 GWEPT 750°C ≤2S

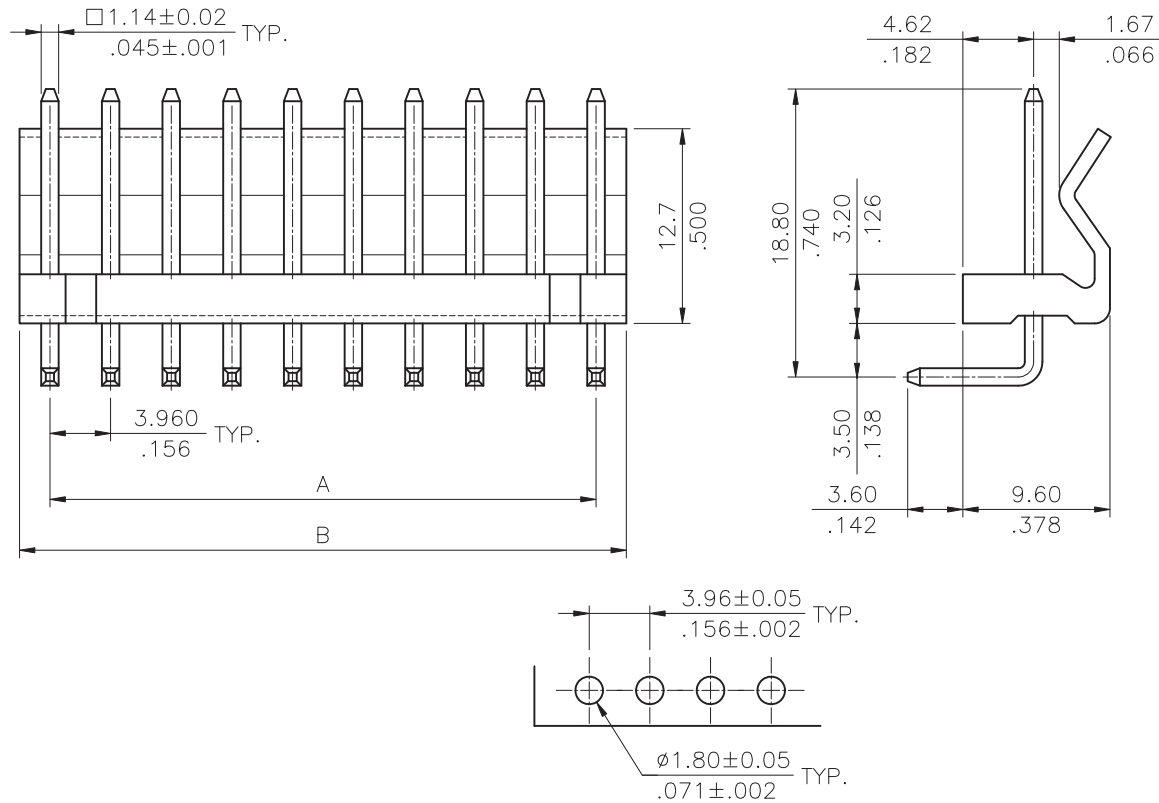

Recommended P.C. Board Layout

Circuits	Dimension	
	A	B
2	3.96(.156)	7.92(.312)
3	7.92(.312)	11.88(.468)
4	11.88(.468)	15.84(.624)
5	15.84(.624)	19.80(.780)
6	19.80(.780)	23.76(.935)
7	23.76(.935)	27.72(1.091)
8	27.72(1.091)	31.68(1.247)
9	31.68(1.247)	35.64(1.403)
10	35.64(1.403)	39.60(1.559)
11	39.60(1.559)	43.56(1.715)
12	43.56(1.715)	47.52(1.871)
13	47.52(1.871)	51.48(2.027)
14	51.48(2.027)	55.44(2.183)
15	55.44(2.183)	59.40(2.339)
16	59.40(2.339)	63.36(2.494)
17	63.36(2.494)	67.32(2.650)
18	67.32(2.650)	71.28(2.806)
19	71.28(2.806)	75.24(2.962)
20	75.24(2.962)	79.20(3.118)

RoHS Compliant

TOLERANCES ARE

MORETHANALL
PCB CONNECTORS
Cable ASSEMBLIES

DRAWING BY CY

CHECKED BY GENIUS

UNIT / mm

SCALE 1 : 1

DATE

SIZE A4

PJECTION

X, ±
.X ± 0.38
.XX ± 0.25
.XXX ± 0.10
ANG ±

照片框

ORDER INFORMATION

KK-RGWC-xx-LF
SERIES | LEADFREE
02-20WAY
GLOW WIRE COMPATIBLE
DIP 90°

煜倫股份有限公司

www.morethanall.com

DESCRIPTION: 3.96MM(.156") RIGHT ANGLE HEADERS