

FEATURES:
 THICKNESS: 0.25mm
 MAT'L: PHOSPHOR BRONZE TIN PLATED
 CURRENT RATING: 3A AC,DC
 VOLTAGE RATING: 250V AC,DC
 TEMPERATURE RANGE: -35°C~105°C
 (INCLUDING TEMPERATURE RISE)
 INSULATION RESISTANCE: OVER 1000MΩ
 WITHSTANDING VOLTAGE: 1000V AC/MINUTE
 APPLICABLE WIRE: AWG#24-28

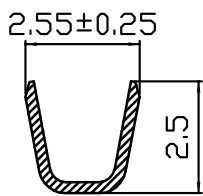

SECTION A-A

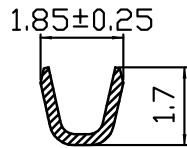

SECTION B-B

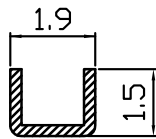

SECTION C-C

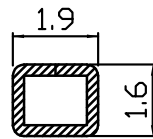

SECTION D-D

JSW-T-24-LF
 LEADFREE
 RoHS Compliant

	PART NO. JSW-T-24		TOLERANCES ARE .X ± 0.25 .XX ± 0.15 .XXX ± 0.1 ANG	DESCRIPTION:				
	DWG NO. JSW-T-24							CHECKED BY CY
焯倫股份有限公司	FILE NO.		DRAWING BY		AREA	REVISIONS	HK	DATE
	UNIT / mm	SCALE 1:1	PROJECTION					