

CONTACT LAYOUT

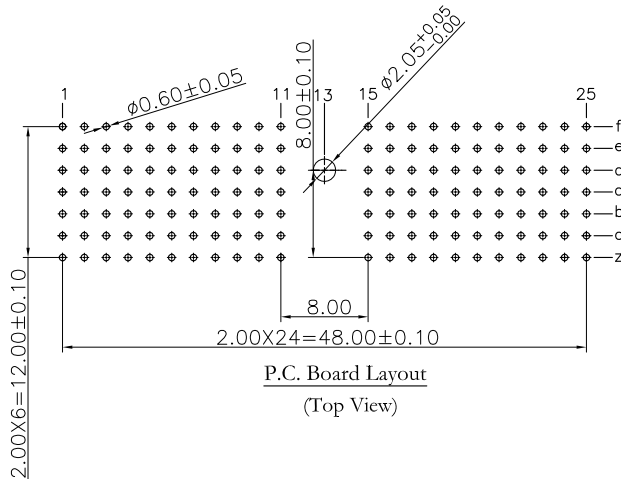

P.C. Board Layout  
(Top View)

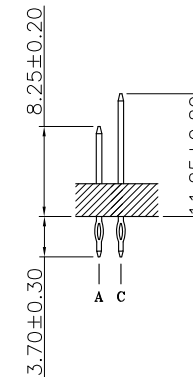

**Material:**

Housing: 30% Glass Filled PBT UL94V-0.  
Contacts: Phosphor Bronze.

**Electrical Characteristics:**

Current Rating: 1 AMP.  
Dielectric Withstanding Voltage: AC 750V For 1 minute.  
Insulator Resistance: 10000MΩ min.at DC 500V.  
Contact Resistance: 20mΩ max.at DC 100mA.  
Operating Temperature: -55°C ~ +105°C .

**RoHS Compliant**

TOLERANCES ARE



煜倫股份有限公司

www.morethanall.com

DRAWING BY CY

CHECKED BY GENIUS

UNIT / mm

SCALE 1 : 1

DATE

SIZE A4

X, ±  
.X ±  
.XX ±  
.XXX ±  
ANG ±

PJECTION

照片框

**ORDER INFORMATION**

HM7A-PP03AC-154-LF

SERIES | | | | LEADFREE  
154 WAY  
AC TYPE  
3.7mm  
PRESS FIT  
MALE

DESCRIPTION: