

**MATERIAL**  
 Contact Pin : Brass  
**SPECIFICATION**  
 Current Rate : 1 AMP  
 Insulation Resistance : 5000MΩMin. at DC 500V  
 Contact Resistance : 15mΩMax.  
 Dielectric Voltage : AC 500V for one minute  
 Operation Temperature : -40°C to + 105°C

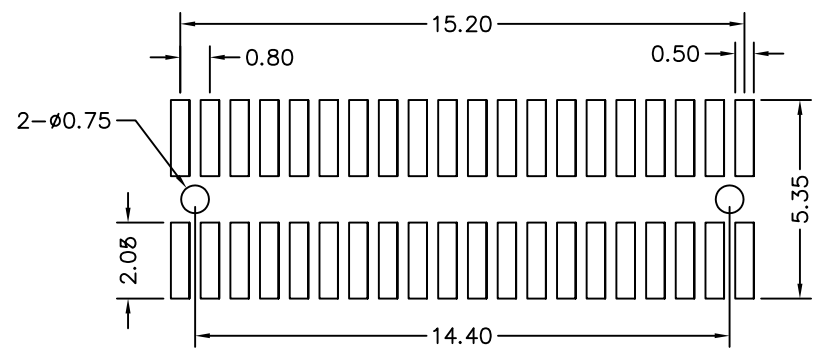
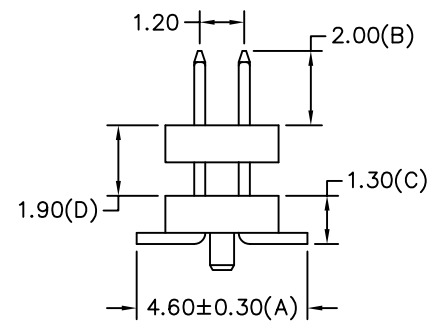
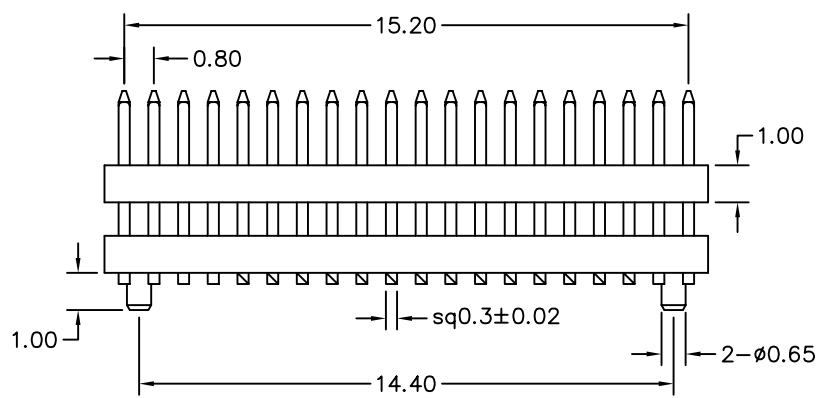

Recommended P.C.B Layout

**RoHS Compliant**

TOLERANCES ARE

X.±
.X±
.XX±
.XXX±
ANG±



**ORDER INFORMATION**

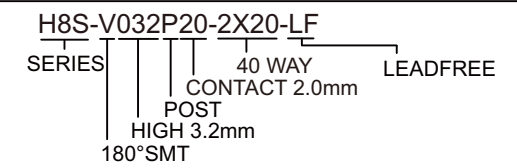

**MORETHANALL**  
 PCB CONNECTORS  
 Cable ASSEMBLIES  
 煜倫股份有限公司  
 www.morethanall.com

DRAWING BY CY	
CHECKED BY GENIUS	
UNIT / mm	SCALE 1 : 1
DATE	
SIZE A4	PJECTION

DESCRIPTION: PIN HEADER 0.8\*1.2mm  
 SMT S/T TYPE, DUAL ROWS DUAL INSULATORS HEIGHT=1.0mm