

PIN	DIMENSIONS			
	A	B	C	D
02	1.25	5.75	2.20	3.75
03	2.50	7.00	3.30	5.00
04	3.75	8.25	4.55	6.25
05	5.00	9.50	4.55	7.50
06	6.25	10.75	6.55	8.75
07	7.50	12.00	6.55	10.00
08	8.75	13.25	6.55	11.25
09	10.00	14.50	6.55	12.50
10	11.25	15.75	8.55	13.75
11	12.50	17.00	8.55	15.00
12	13.75	18.25	8.55	16.25

Specification
 1.Current Rating:1A AC/DC
 2.Voltage Rating:50V AC/DC
 3.Contact Resistance:30mΩ Max.
 4.Insulation Resistance:100MΩ Min.
 5.Withstand Voltage:AC500V/Minute
 6.Operating Temperature:-25°C~+85°C
 Material:
 1.Housing:Thermoplastic UL94V-0
 2.Contact Pin:Copper Alloy T=0.20mm
 3.Tab:Copper Alloy T=0.20mm
 Finish:
 1.Housing:Natural
 2.Contact Pin:Tin Plated

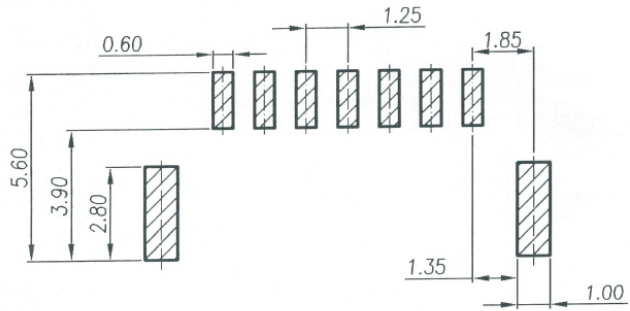

RECOMMENDED P.C.B LAYOUT

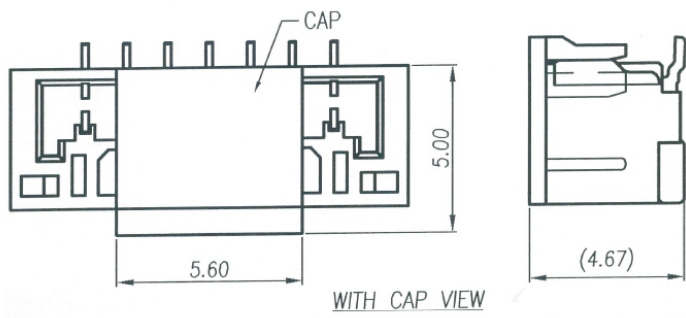
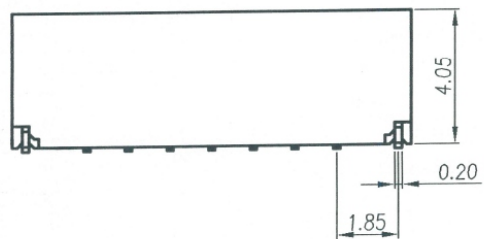
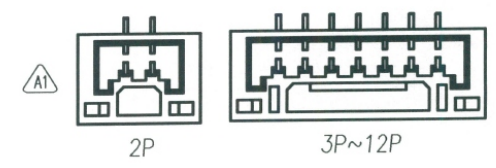

RoHS Compliant

TOLERANCES ARE
 X, ±
 .X ± 0.25
 .XX ± 0.15
 .XXX ± 0.08
 ANG ±

照片框

ORDER INFORMATION

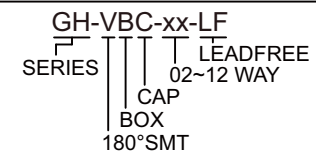

MORETHANALL
 PCB CONNECTORS
 Cable ASSEMBLIES
 煜倫股份有限公司
 www.morethanall.com

DRAWING BY CY		UNIT / mm	SCALE 1 : 1	DATE	SIZE A4	PJECTION
CHECKED BY GENIUS						

DESCRIPTION: