

FEATURES:

- . 10 Circuits
- . Housing: Glass Filled LCP, UL 94V-0
- . Contact: Phosphor Bronze
- . 10 Circuits modular nut fits into same space and footprint as 30 Circuits signal module
- . Sturdy male blade pins avoid bending and dissipate heat
- . Post-plated pins provide high reliability
- . Code key insertion holes secure code keys and provide proper mating alignment
- . PCB retention pegs provide additional hold-down

SPECIFICATIONS:

- . Current rating: 3.0A
- . Voltage rating: 1000V
- . Temperature range: -55°C ~+ 125°C
- . Contact resistance: 10mΩ max.
- . Insulation resistance: 5000mΩ min.
- . Dielectric withstanding voltage: 750V AC

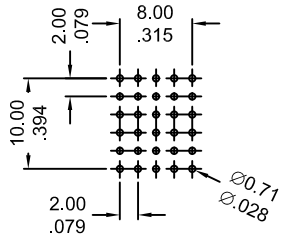
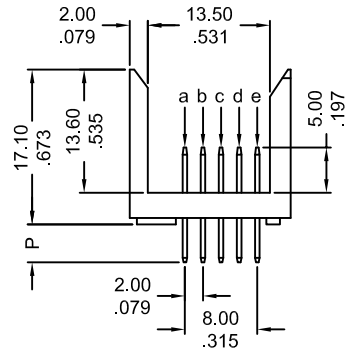

Press fit pin

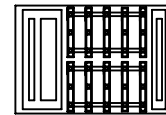
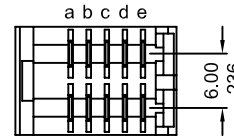
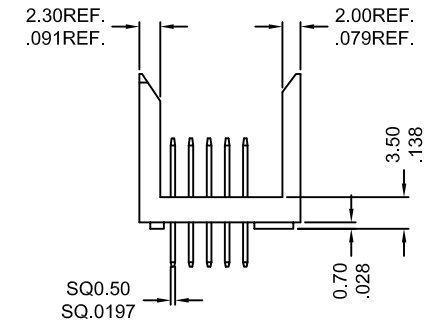
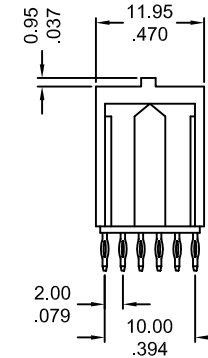
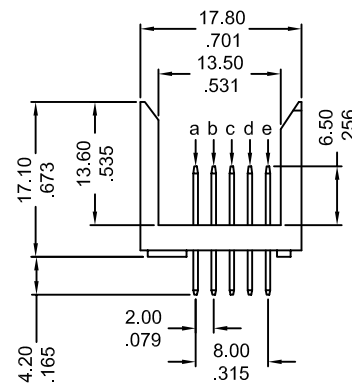
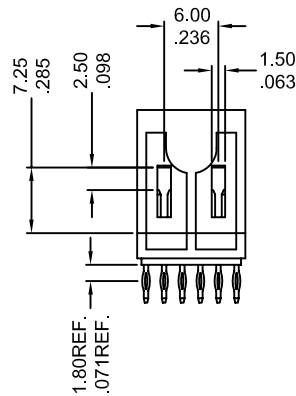

Recommended P.C Board

Hole Layout

UNIT: MM
INCH

Thickness: $\frac{1.60}{.063}$ & $\frac{2.40}{.094}$

RoHS Compliant

TOLERANCES ARE

MORETHANALL
PCB CONNECTORS
Cable ASSEMBLIES

DRAWING BY CY

X, ±

CHECKED BY GENIUS

.X ±

UNIT / mm

SCALE 1 : 1

.XX ±

DATE

.XXX ±

ANG ±

SIZE A4

PJECTION

照片框

ORDER INFORMATION

FUP-PP0465-5X02-LF
SERIES | | | | LEADFREE
| | | | 10 WAY
| | | | CONTACT 6.5mm
| | | | DIP 4.2mm
| | | | PRESS FIT
| | | | MALE

DESCRIPTION: .079" (2.00mm) Pitch Male Power (Futurebus) Header

煜倫股份有限公司

www.morethanall.com