

1. Material: Iserlater: PBT UL94V-0 Color: Black
Metal: Pre-tinned Phosphor bronze
2. Make kinks on the first and end terminal.
3. When the locking mechanism is in the open position dimension D is 0.20-0.30 mm
3. When the locking mechanism is in the closed position dimension D is 0.000 mm

Specifications:
Current rating: 1A AC DC
Voltage rating: 200V AC DC

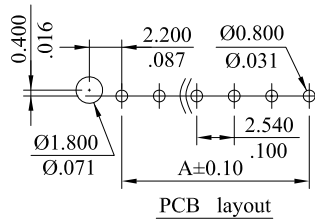
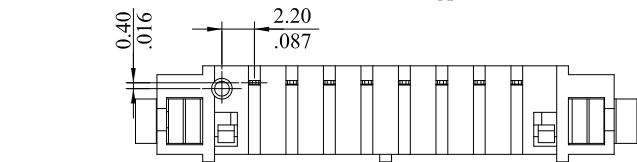
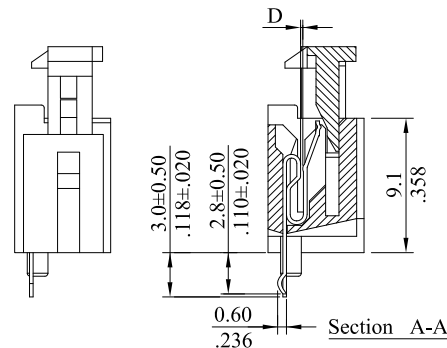
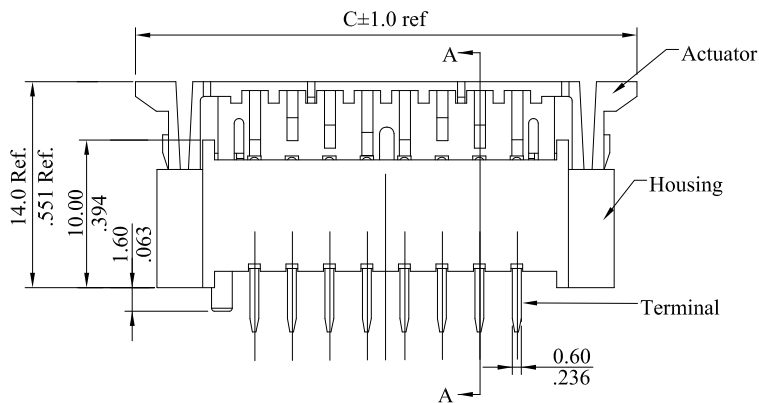
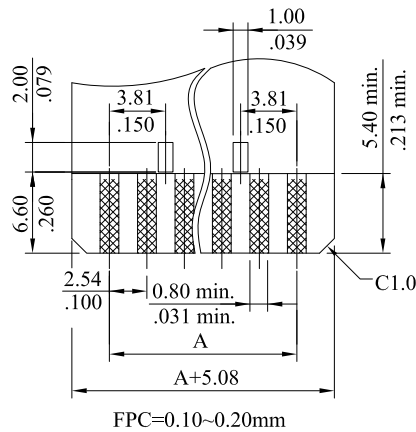
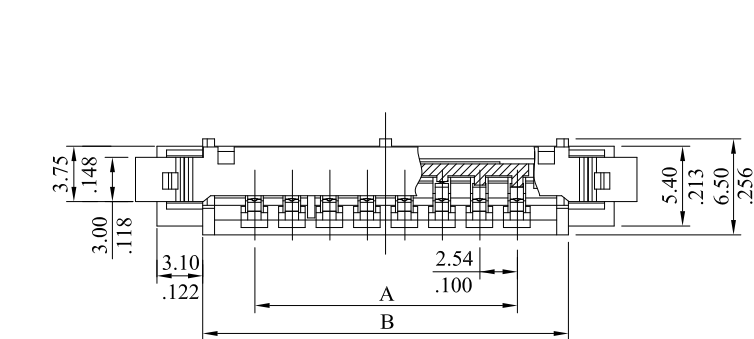
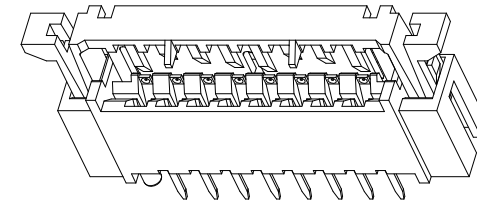

20	48.26(1.900)	55.26(2.176)	64.44(2.538)
19	45.72(1.800)	52.72(2.076)	61.92(2.438)
18	43.18(1.700)	50.18(1.976)	59.38(2.338)
17	40.64(1.600)	47.64(1.876)	56.84(2.238)
16	38.10(1.500)	45.10(1.776)	54.30(2.138)
15	35.56(1.400)	42.56(1.676)	51.76(2.038)
14	33.02(1.300)	40.02(1.576)	49.22(1.938)
13	30.48(1.200)	37.48(1.476)	46.68(1.838)
12	27.94(1.100)	34.94(1.376)	44.14(1.738)
11	25.40(1.000)	32.40(1.276)	41.60(1.638)
10	22.86(.900)	29.86(1.176)	39.06(1.538)
9	20.32(.800)	27.32(1.076)	36.52(1.438)
8	17.78(.700)	24.78(.976)	33.98(1.338)
7	15.24(.600)	22.24(.876)	31.44(1.238)
6	12.70(.500)	19.70(.776)	28.90(1.138)
5	10.16(.400)	17.16(.676)	26.36(1.038)
CIRCUITS	DIM.A	DIM.B	DIM.C

3	ACTUATOR	PBT		1
2	HOUSING	PBT		1
1	TERMINAL	C5191 1/2H	Tin	*
NO.	NAME	MATERIAL	FINISH	QTY.

RoHS Compliant

TOLERANCES ARE

MORETHANALL
PCB CONNECTORS
Cable ASSEMBLIES

DRAWING BY CY

X, ±

CHECKED BY GENIUS

X, ±

UNIT / mm

SCALE 1 : 1

.XX ±

DATE

.XXX ±

ANG ±

SIZE A4

PPOJECTION

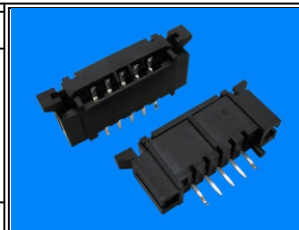

ORDER INFORMATION

FPC-DZAP-xx-LF

SERIES | LEADFREE
05-20 WAY
POST
SINGLE CONTACT
ZIF
DIP 180°

DESCRIPTION: 2.54mm FPC connector

煜倫股份有限公司

www.morethanall.com