

Material Description:

Contact: Phosphor Bronze Tin-Leadplated

Solder Tab: Phosphor Bronze Tin-plated

Housing: Thermoplastic (UL94V-0)

Slider: Thermoplastic (UL94V-0)

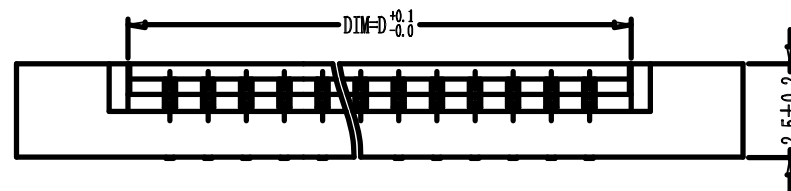
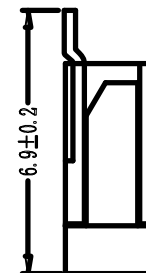
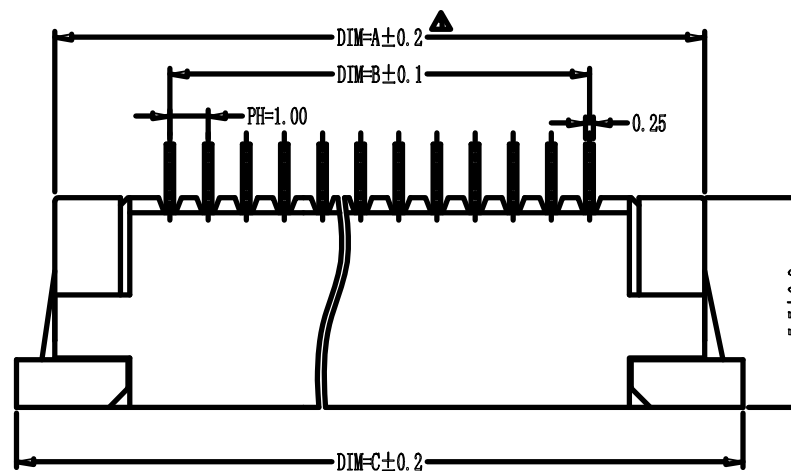
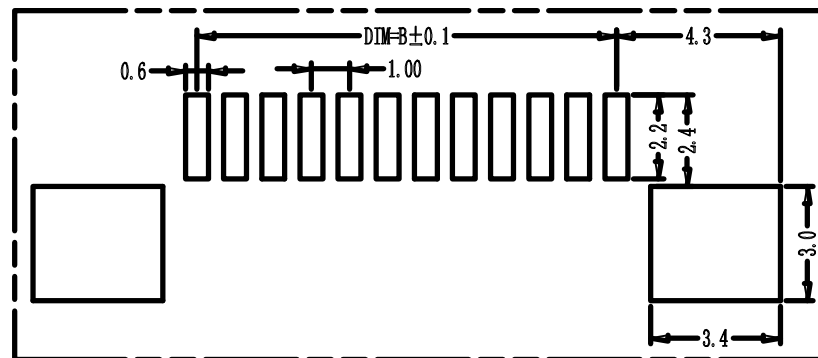

No. of Contacts	DIM. A	DIM. B	DIM. C	DIM. D
40	45.1	39.0	47.0	41.1

RoHS Compliant

TOLERANCES ARE

MORETHANALL
PCB CONNECTORS
Cable ASSEMBLIES

煜倫股份有限公司

www.morethanall.com

DRAWING BY CY

CHECKED BY GENIUS

UNIT / mm SCALE 1:1

DATE

SIZE A4

X, ±
.X ±
.XX ±
.XXX ±
ANG ±

PPOJECTION

照片框

ORDER INFORMATION

FPA-WZA25-40-LF
SERIES | | | LEADFREE
40 WAY
HIGH 2.5mm
UPPER CONTACT
ZIF
90°SMT

DESCRIPTION: FFC/FPC Connector ZIF Right Angle Lower Contact Type 1.0 mm H=2.5mm