

Recommended P.C.B Layout(Top Side)
(PCB BOARD TOLERANCE±0.05)

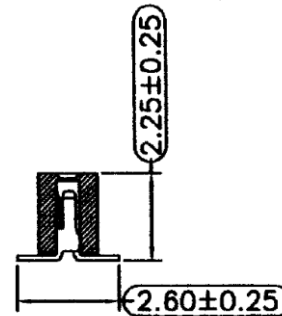
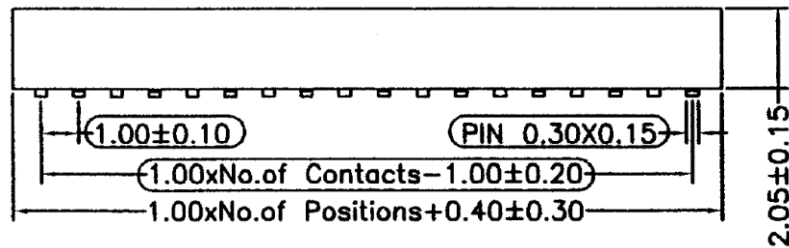

NOTES:

- Current Rating: 1.0AMP
- Contact Resistance: 20mΩ Max
- Withstand Voltage: 500V AC/DC
- Insulation Resistance: 1000MΩ Min
- Operation Temperature: -40°C to +105°C

- Contact Material: Phosphor Bronze
- Contact plating: Au or Sn over Ni
- Insulator Material: PA9T+30%GF UL94V-0

RoHS Compliant

TOLERANCES ARE

MORETHANALL
PCB CONNECTORS
Cable ASSEMBLIES

煜倫股份有限公司

www.morethanall.com

DRAWING BY CY

CHECKED BY GENIUS

UNIT / mm

SCALE 1 : 1

DATE

SIZE A4

P PROJECTION

X, ±
.X ± 0.40
.XX ± 0.25
.XXX ± 0.15
ANG ±

照片框

ORDER INFORMATION

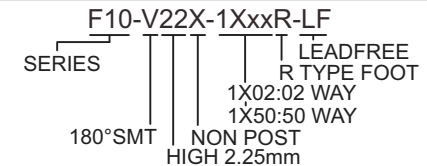

DESCRIPTION: