

Recommended P.C. Board SMD Layout

Specifications

Current Rating : 3 Amps
 Insulator Resistance : 1000 Megohms min.
 Contact Resistance : 20 m ohms max.
 Dielectric Withstanding : AC 600V
 Operating Temperature : -40°C ~ +105°C
 Contact Material : Phosphor Bronze
 Insulator Material : Polyester, UL 94V-0 Nylon-6T
 Contact Plated : See Option
 Standard: Full Gold Flash

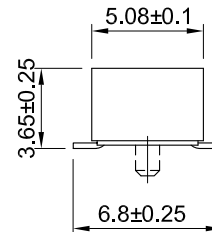
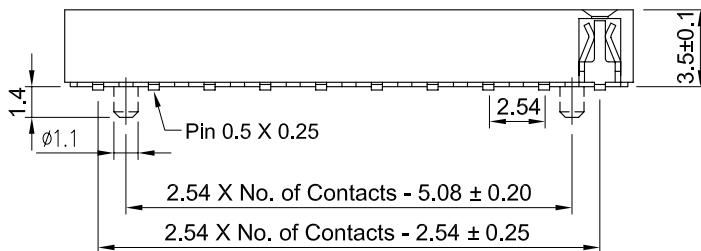
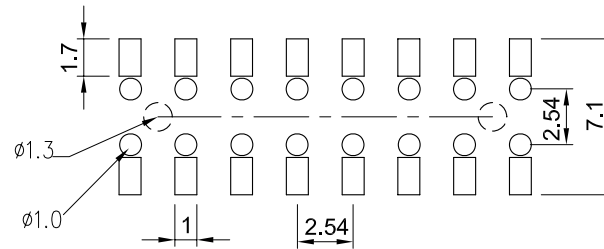
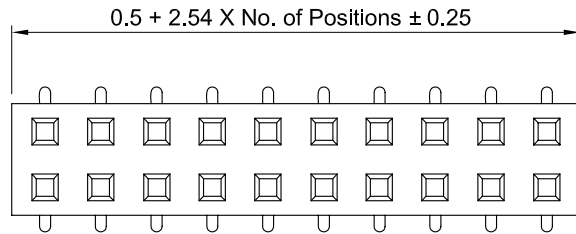

RoHS Compliant

TOLERANCES ARE

MORETHANALL
PCB CONNECTORS
Cable ASSEMBLIES

煜倫股份有限公司

www.morethanall.com

DRAWING BY CY

CHECKED BY GENIUS

UNIT / mm

SCALE 1 : 1

DATE

SIZE A4

X. ± 0.50

.X ± 0.20

.XX ± 0.10

.XXX ±

ANG ±

PJECTION

照片框

ORDER INFORMATION

F-Z36P-2Xxx-LF

SERIES	POST	LEADFREE	
	HIGH 3.65mm	2X02:04WAY	
	BOTTOM ENTRY SMT	2X40:80WAY	

DESCRIPTION: Female Header P:2.54 X 2.54mm Profile : 3.5mm, Dual Row, SMD Type