

● PCB HOLES SIZE REQUIREMENTS

Drill Hole Diameter :1.15~0.03mm

Plating: 0.001" To 0.003" Copper and 0.0003 Minimum Tin

Finish Hole Diameter : 1.0+0.07mm

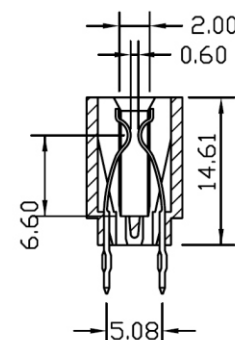

Regular Contacts
(Low Profile)

Section A-A

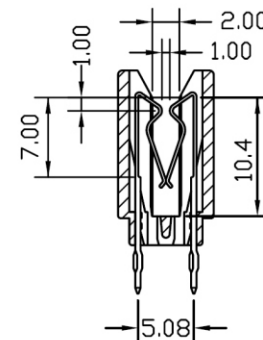

MBB Contacts
(High Profile)

Section A-A

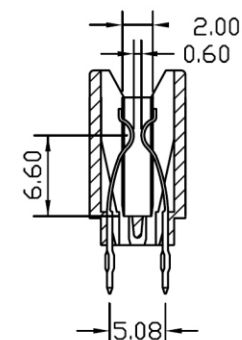

Regular Contacts
(High Profile)

Section A-A

E-P-xxx-LF

LEADFREE

RoHS Compliant

MORETHANALL
CONNECTORS
ASSEMBLIES

煜倫股份有限公司

PART NO. **E-P-xxx**

DWG NO. **E-P-xxx**

FILE NO.

UNIT / mm

SCALE 1:1

CHECKED BY CY

DRAWING BY

PROJECTION

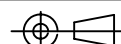

TOLERANCES ARE

.X ± 0.2

.XX ±

.XXX ±

AWG

DESCRIP TION:

AREA

REVISIONS

HK

DATE