

***P.C.B. LAYOUT**

MATERIAL-

Insulator: Nylon 9T (Black) ,UL94V-0.
 Contact: Phosphor Bronze or Brass(Standard is Brass)
 Contact Plating: GOLD Plating Over NICKEL In Contact Area.
 Tin Plating Over Nickel In Dip Area.
 NICKEL Plating In A'SS AREA.
 Shell: Steel ,Nickel Plated.

SPECIFICATION-

Current Rating: 5Amps.
 Insulator Resistance: 1000MegΩ Min ,at 500V DC.
 Contact Resistance: 20millΩ Max.
 Withstanding Voltage: 1000V AC/minute.
 Reflow Processing Temperature & Time: 240°C For 6 Seconds.
 Peak Reflow Processing Temperature & Time: 230°C For 60 Seconds.
 Operating Temperature: -55°C~ +125°C.

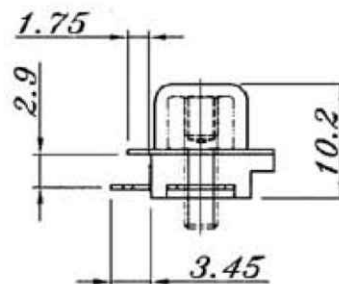

RoHS Compliant

TOLERANCES ARE

MORETHANALL
 PCB CONNECTORS
 Cable ASSEMBLIES

DRAWING BY CY

CHECKED BY GENIUS

UNIT / mm

SCALE 1 : 1

DATE

SIZE A4

PJECTION

X, ±
 .X ±
 .XX ±
 .XXX ±
 ANG ±

照片框

ORDER INFORMATION

DW-SNZ1-25-LF
 SERIES | CLIP | LEADFREE
 | | 25 WAY
 NUT
 FEMALE

煜倫股份有限公司

www.morethanall.com

DESCRIPTION: