

SPECIFICATIONS

ELECTRICAL CHARACTERISTICS:

Contact Current Rating: 5 Amperes.
 Dielectric Withstanding Voltage: AC 1000/60sec.r.m.s.
 Insulation Resistance: 5000 Medohms Minimum
 Contact Resistance: 30 Milliohms Maximum.
 Operating Temperature: -55°C to +105°C.

MECHANICAL CHARACTERISTICS:

Contact Insertion Force: 341 g. Maximum.
 Contact Separation Force: 21 g. Minimum.

MATERIALS:

Contacts: Brass.
 Insulator: PBT UL 94V-0 Rated.
 Shell: Cold Roller Steel.

FINISHES:

Contact: Gold Flash Selectire
 Shell: Nickel Plated.
 4#40 Threaded Riveted & Jack Screws in Bulk

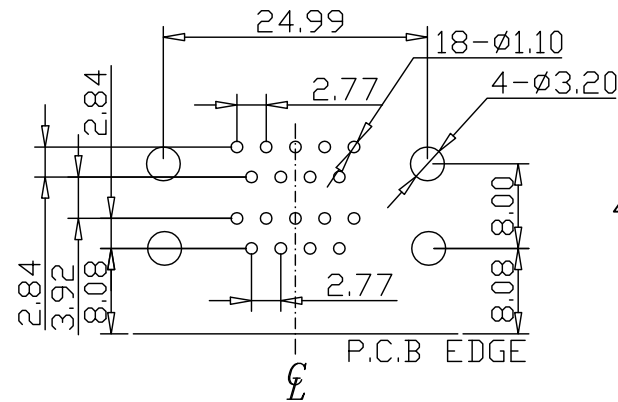
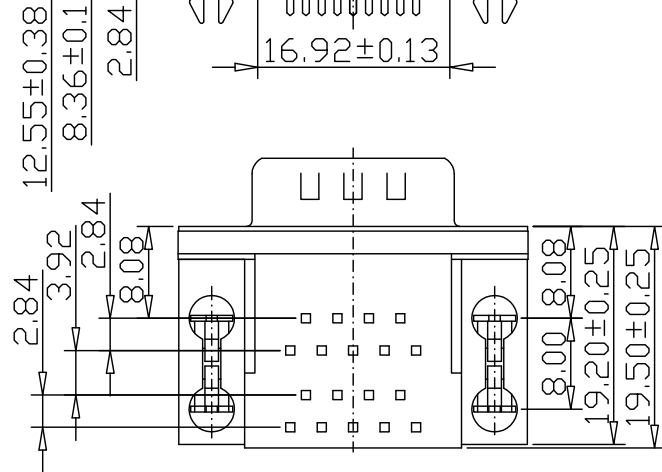
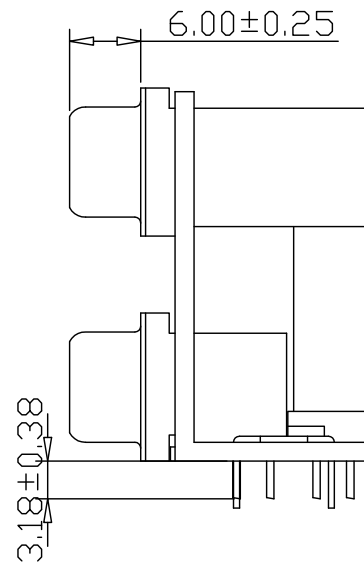
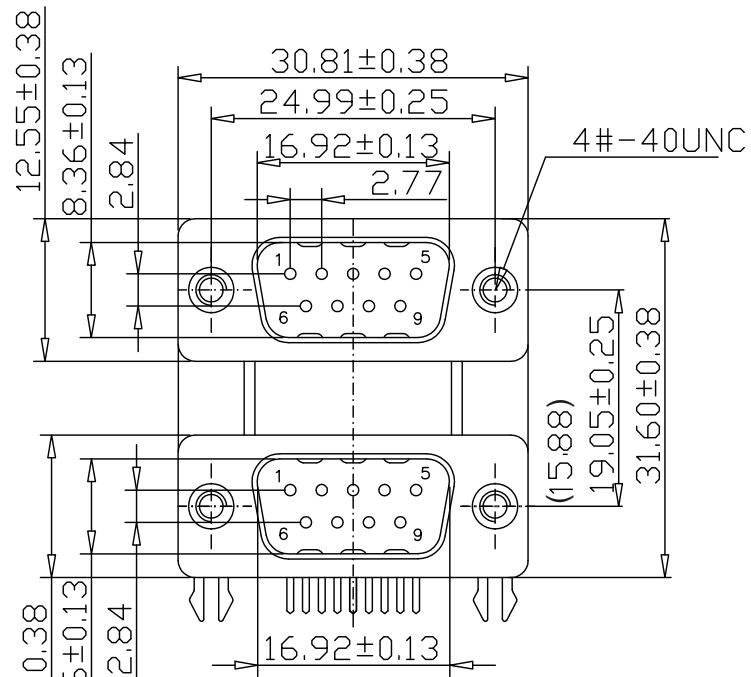

RECOMMENDED P.C.B LAYOUT

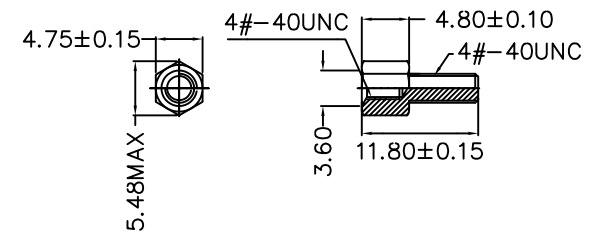

RoHS Compliant

TOLERANCES ARE

MORETHANALL
 PCB CONNECTORS
 Cable ASSEMBLIES

DRAWING BY CY

CHECKED BY GENIUS

UNIT / mm SCALE 1 : 1

DATE

SIZE A4 PPROJECTION

X. ±
 .X ±
 .XX ±
 .XXX ±
 ANG ±

照片框

ORDER INFORMATION

DRB1-MN15H-0909-LF
 SERIES LEADFREE
 09 TO 09 WAY
 HEX SCREW
 SPACING 15.88mm
 NUT
 MALE TO MALE

DESCRIPTION:

煜倫股份有限公司

www.morethanall.com