

SPECIFICATIONS

ELECTRICAL CHARACTERISTICS:

Contact Current Rating:3 Amperes.
 Dielectric Withstanding Voltage: AC 1000/60sec.r.m.s.
 Insulation Resistance:5000 Medohms Minimum.at DC 500V.
 Contact Resistaance:25 Milliohms Maximum.
 Operating Temperature:-55°C to+105°C.

MECHANICAL CHARACTERISTICS:

Contact Insertion Force:341 g.Maximum.
 Contact Seperation Force:21 g.Maximum.

MATERIALS:

Contacts:Bass.
 Insulator: PBT UL 94V-0 Rated.
 Shell: Cold Roller Steel.

FINISHES:

Contact:Gold Flash.

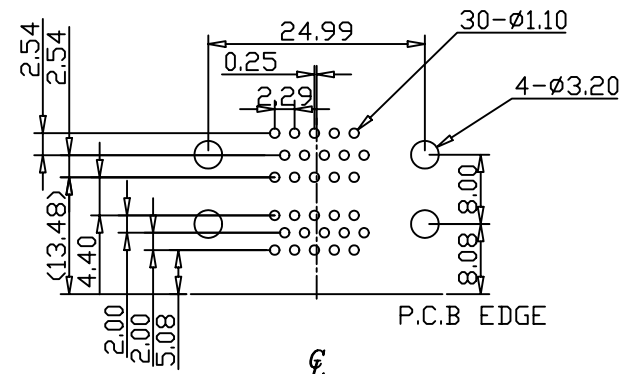
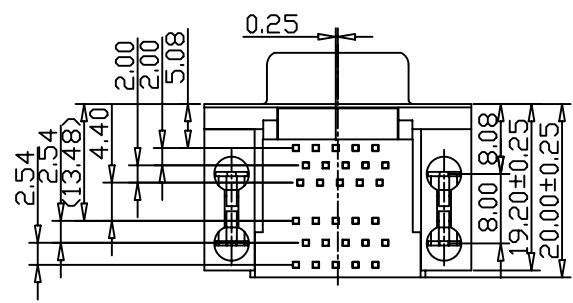

RECOMMENDED P.C.B LAYOUT



PART NO. DRB1-FN5-3535		CHECKED BY CY		TOLERANCES ARE .X ± 0.2 .XX ± .XXX ± AWG	DESCRIP TION:			
DWG NO. DRB1-FN5-3535		DRAWING BY						
FILE NO.		PROJECTION		AREA	REVISIONS	HK	DATE	

煜倫股份有限公司

UNIT / mm

SCALE 1:1