

Pin Number :
13,25,12,24,11,23,10,22,9,21,8,20,7,19,6,18,5,17,4,16,3,15,2,14,1

Recommended PCB Layout

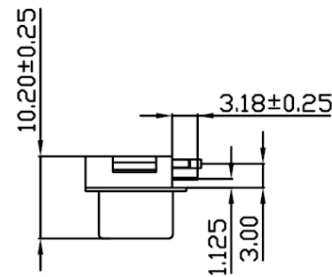

Material And Finish
 Shell -Steel zinc plated or tin plated
 Bracket-Brass strip-H nickel plated
 Screw-Brass nickel plated
 Insulator-NYLON 6T with glass-fiber reinforced UL-94V0,color black
 Contact Material-
 Plug-Phospor bronze

Duplex plated as follows:
 A-.000030[.00076]gold on mating end.
 tin-lead on termination end, with entire contact nickel
 B-.000015[.00038]gold on mating end.
 tin-lead on termination end, with entire contact nickel
 C-Gold flash on mating end.
 tin-lead on termination end, with entire contact nickel

Specifications
 Rated current
 5A
 Rated Voltage
 300V DC
 Withstanding Voltage
 500V(r.m.s) AC for 1 minute
 Insulation Resistance
 more than 1000M ohm at 500V DC
 Contact Resistance
 13m ohm Max
 Dielectric Strength
 1000V AC Min for 1 minute
 Temperature
 -55 °C~+105 °C

RoHS Compliant

TOLERANCES ARE

MORETHANALL
 PCB CONNECTORS
 Cable ASSEMBLIES

煜倫股份有限公司

www.morethanall.com

DRAWING BY CY

CHECKED BY GENIUS

UNIT / mm SCALE 1 : 1

DATE

SIZE A4

X, ±
 .X ±
 .XX ±
 .XXX ±
 ANG ±

PPOJECTION

照片框

ORDER INFORMATION

DR11-PNZ2-25-LF
 SERIES | | | LEADFREE
 | | | 25 WAY
 | | | CLIP
 | | | NUT
 | | | MALE

DESCRIPTION: