

NOTES:

- 1.MATERIAL
- 1.1 Insulator: PBT+30% Glass Fiber (UL94V-0)
 - 1.2 Contact: Brass
 - 1.3 Contact Plated: Gold
 - 1.4 Shell: Steel, Nickel plated
- 2.SPECIFICATION
- 2.1 Current Rate: 5 Amps
 - 2.2 Insulator Resistance: 1000MΩ Min. at 500V DC
 - 2.3 Dielectric Strength: 500V Per minute
 - 2.4 Operation Temperature: -55°C to +105°C

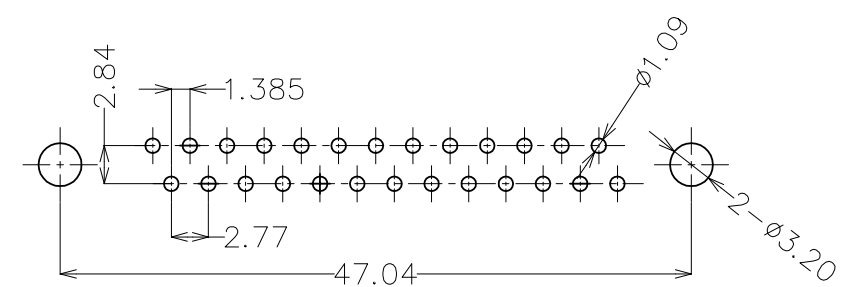
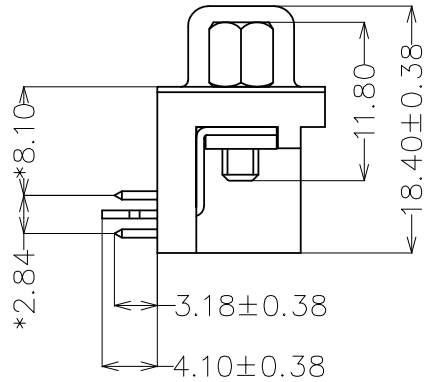
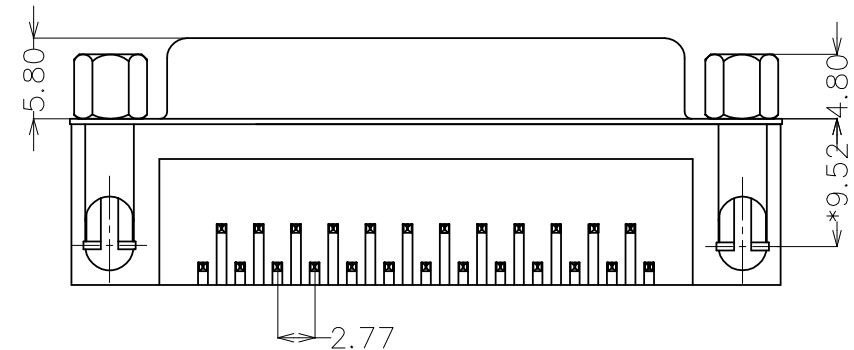

P.C.B. LAYOUT (TOLERANCE ±0.05)
P.C.B. LAYOUT

DR-SxNJ-25-LF
LEADFREE
S: SEMI GOLD
G: FULL GOLD
RoHS Compliant



PART NO. DR-SxNJ-25		CHECKED BY CY		TOLERANCES ARE X.± .X±0.38 .XX±0.25 .XXX±0.15 ANG	DESCRIPTION: DR25母叉鉗鎖 8.1 RoHS
DWG NO. DR-SxNJ-25		DRAWING BY			
FILE NO.		PROJECTION		AREA	REVISIONS
UNIT / mm	SCALE 1:1			DATE	

煜倫股份有限公司