

Note:

1.Material:

- 1.1 Insulator: High temperature thermoplastic with g.f,UL94v-0
- 1.2 Contact: Copper alloy,t=0.20mm
- 1.3 Shell: Spcc,t=0.30mm

2.Specification:

- 2.1 Current rating: 1 A Max.
- 2.2 Dielectric withstanding voltage: 750 V(ac) for 1 min.
- 2.3 Contact resistance: 30 mΩ Max.
- 2.4 Insulation resistance: 1000 MΩ Min.
- 2.5 Total mating force: 7.0 Kgf Max.
- 2.6 Total unmating force: 1.5 Kgf Min.
- 2.7 Temperature range: -55°C~85°C

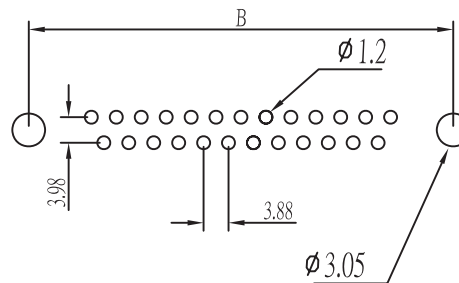
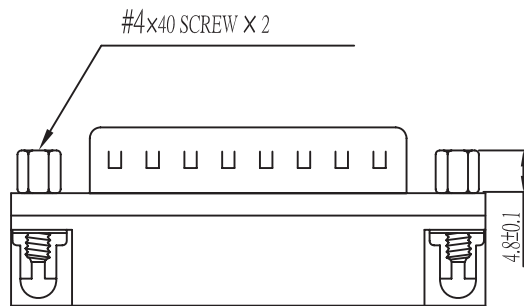

P.C.B. LAYOUT

PART NO.	A±0.25	B±0.2	C±0.2	D±0.2	E±0.2	I±0.1
DR-PSNJ-09	30.81	24.99	16.92	8.38	12.55	2.84
DR-PSNJ-15	39.25	33.32	25.25	8.38	12.55	2.84
DR-PSNJ-25	53.04	47.04	38.96	8.38	12.55	2.84
DR-PSNJ-37	69.32	63.50	55.42	8.38	12.55	2.84

RoHS Compliant

TOLERANCES ARE

MORETHANALL
PCB CONNECTORS
Cable ASSEMBLIES

煜倫股份有限公司

www.morethanall.com

DRAWING BY CY

CHECKED BY GENIUS

UNIT / mm

SCALE 1 : 1

DATE

SIZE A4

X, ±
.X ± 0.30
.XX ± 0.20
.XXX ± 0.10
ANG ± 1°

PPOJECTION

照片框

ORDER INFORMATION

DR-PSNJ-xx-LF
SERIES | | | LEADFREE
| | | 09~37 WAY
| | | JACKSCREW
| | | NUT
| | | SEMI GOLD
| | | MALE

DESCRIPTION: D-SUB RIGHT ANGLE P. B. C TYPE (M)