

**MATERIAL:**

INSULATOR : PBT+30% GLASS FIBER (UL 94V-0) BLACK.  
 CONTACT MATERIAL : BRASS.  
 CONTACT FINISH : SEMIGOLD 30u" ON MATING END, TIN-LEAD ON TERMINATION END, WITH ENTIRE CONTACT NICKEL UNDERPLATED.  
 SHELL FINISH : STEEL NICKEL PLATED.

**SPECIFICATION:**

CURRENT RATING : 5 AMP  
 DIELECTRIC WITHSTANDING VOLTAGE : 1000V PER MINUTE.  
 INSULATION RESISTANCE : 1000MW MIN. AT 500V DC.  
 CONTACT RESISTANCE : 15mW MAX. 10 SES.  
 OPERATING TEMPERATURE : -55. C ~ +105. C.

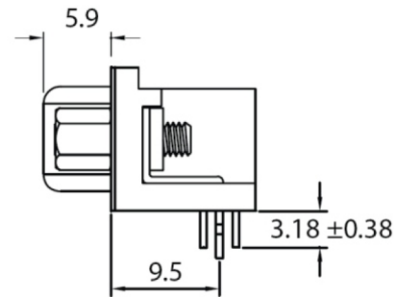
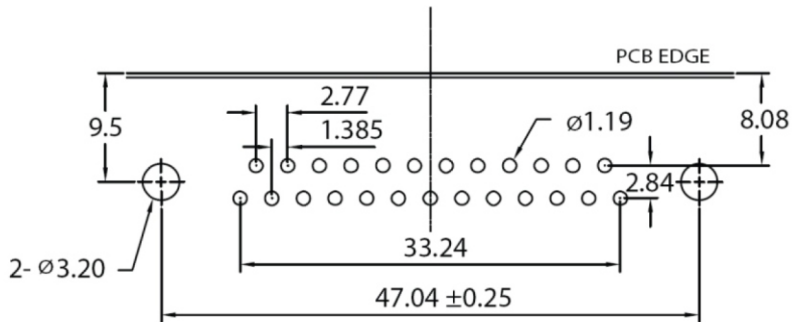
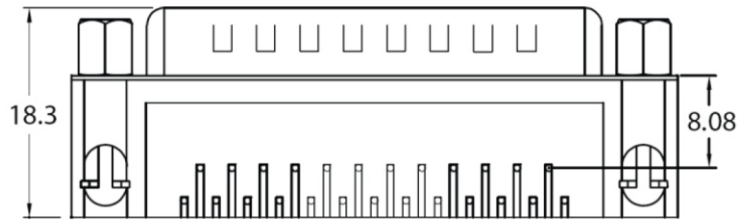

**DR-PS30NJ-25-LF**  
 LEADFREE  
**SEMIGOLD 30u**

**RoHS Compliant**



PART NO. **DR-PS30NJ-25**

DWG NO. **DR-PS30NJ-25**

CHECKED BY CY

TOLERANCES ARE

DESCRIP TION:

FILE NO.

DRAWING BY

.X ± 0.2  
.XX ±  
.XXX ±  
AWG

AREA

REVISIONS

HK

DATE

焯倫股份有限公司

UNIT / mm

SCALE 1:1

PROJECTION

