

Specifications :

- Voltage rating: 250V AC / DC
- Current rating: 10A AC / DC
- Withstanding voltage: 1500V AC/minute
- Temperature range: -25°C~+85°C
- Insulation resistance: ≥1000MΩ
- Contact resistance: ≤10mΩ
- After environmental testing: ≤20mΩ

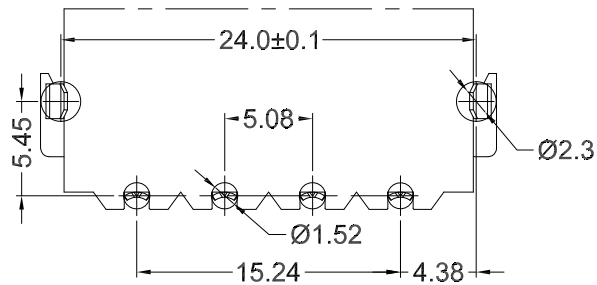

Recommended P.C.B Layout
General Tolerance±0.05

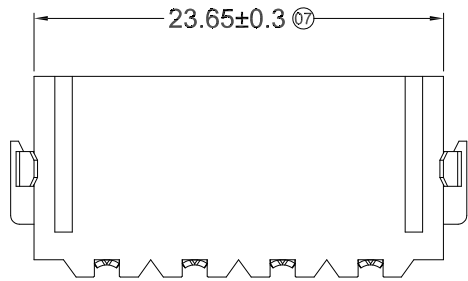
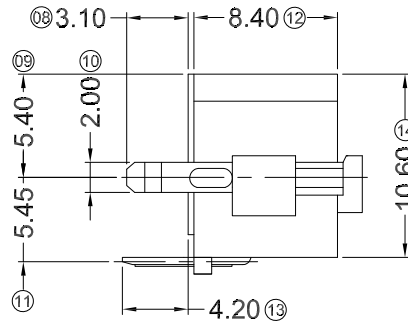

RoHS Compliant

TOLERANCES ARE

MORETHANALL
PCB CONNECTORS
Cable ASSEMBLIES

DRAWING BY CY

CHECKED BY GENIUS

UNIT / mm

SCALE 1 : 1

DATE

SIZE A4

X, ±
.X ± 0.25
.XX ± 0.15
.XXX ± 0.08
ANG ±

PPOJECTION

照片框

ORDER INFORMATION

DP-PLMBK-04-LF
SERIES | LEADFREE
BLACK | 04WAY
METAL | LEFT ANGLE
MALE

煜倫股份有限公司

www.morethanall.com

DESCRIPTION: 5.08mm Crimp Style Connectors