

**SPECIFICATIONS :**

1. CURRENT RATING : AC : 100V 2A.  
DC : 24V 1A.
2. CONTACT RESISTANCE : 30m OHM MAX.
3. INSULATION RESISTANCE : DC 500V 100M OHM MIN.
4. VOLTAGE RESISTANCE : AC 500V 1 MINUTE.
5. INSERTION FORCE : 5KG MAX.
6. WITHDRAWAL FORCE : 1KG MIN.
7. LIFE TEST : 5,000 CYCLE MIN. AFTER TESTING, CONTACT RESISTANCE SHALL NOT EXCEED 100m OHM.

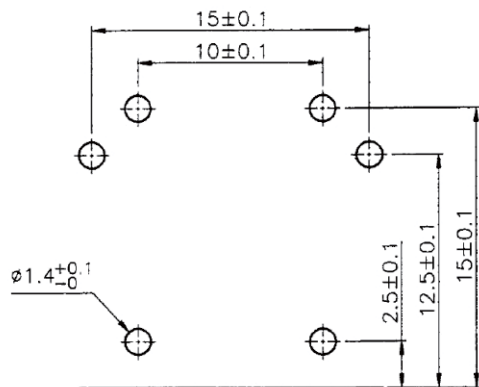

PCB HOLE PATTERN  
(TOP VIEW)

4.	EARTH TERMINAL	1	PBSR-H 0.25t	TIN	
3.	CONTACTOR	4	BSR-H 0.7t	TIN	
2.	COVER	1	P.B.T.		UL94V-0
1.	BODY	1	P.B.T.		UL94V-0
P/N	PART NAME	Q'TY	MATERIAL	PLATING	REMARKS

**RoHS Compliant**

TOLERANCES ARE

**MORETHANALL**  
PCB CONNECTORS  
Cable ASSEMBLIES

DRAWING BY CY

X. ±

CHECKED BY GENIUS

.X ±

UNIT / mm

SCALE 1 : 1

.XX ±

DATE

.XXX ±

ANG ±

SIZE A4

PJECTION

照片框

**ORDER INFORMATION**

DJ-SQ-04-LF  
SERIES | LEADFREE  
| 04 WAY  
| SQUARE  
| ALL PLASTIC

煜倫股份有限公司

www.morethanall.com

DESCRIPTION: