

NOTES:

*** Material:**

Body: Nylon66, Glass Filled,UL 94-0 Rated Color: Black
 Ejector: Nylon66, Glass Filled UL 94V-0 Rated. Color: Natural
 Contact: Brass
 Contact Plating: Gold Plating Over Nickel
 On Contact Area Tin/Lead Plating
 On Terminal

*** Mechanical:**

Normal Force: 160 Grams
 Insertion Force: 4 OZ. Max. Per Mated Pair
 Withdrawal Force: 30 Grams Min. Per Mated Pair

*** Electrical Specification**

Contact Resistance: 30 Milliohms Max. Initial
 Insulation Resistance: 1000 Megohms Min. At 500V DC
 Dielectric Withstanding Voltage: 10000V AC, One Minute Hold

*** Environmental:**

Operating Temperature: -55°C TO +105°C

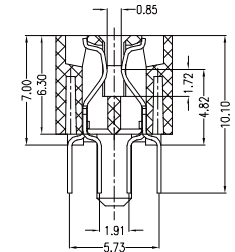
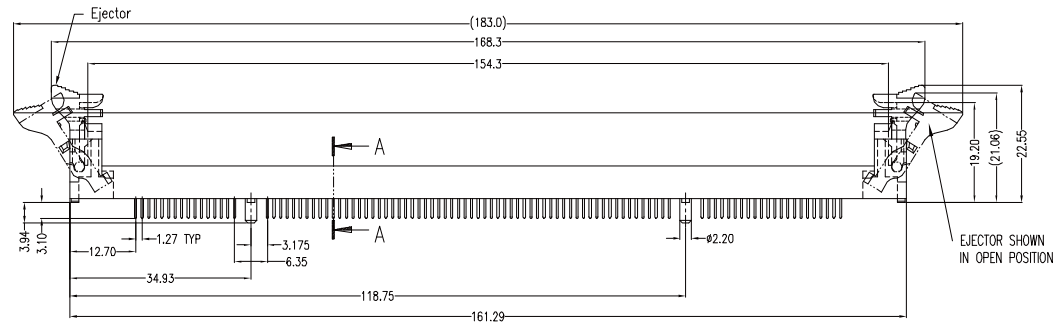
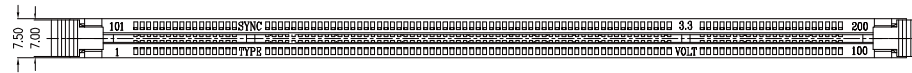

SECT A-A
 SCAL:3:1

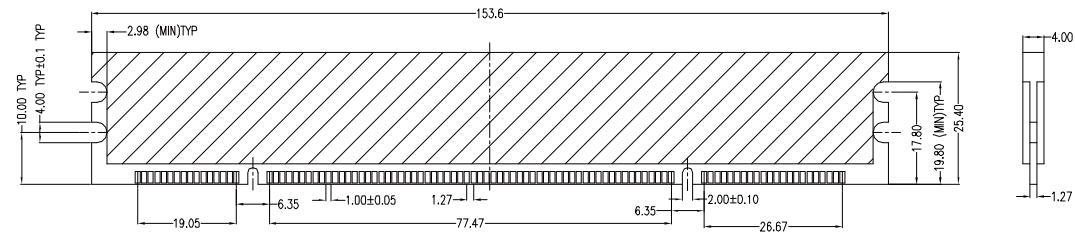
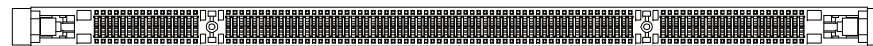

Recommended Daughter Card

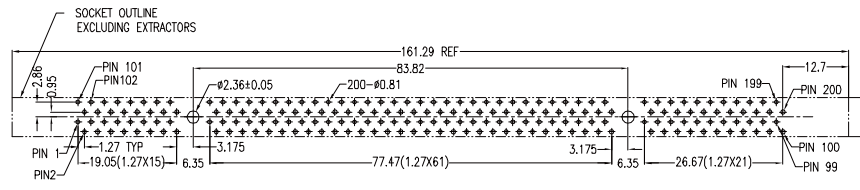

Recommended P.C.B Layout

RoHS Compliant

TOLERANCES ARE

MORETHANALL
 PCB CONNECTORS
 Cable ASSEMBLIES

DRAWING BY CY
 CHECKED BY GENIUS
 UNIT / mm SCALE 1 : 1
 DATE

X, ±
 .X ±
 .XX ±
 .XXX ±
 ANG ±

照片框

ORDER INFORMATION

DIM-DP-200-LF
 SERIES | LEADFREE
 | 200WAY
 POST
 DIP 180°

煜倫股份有限公司

www.morethanall.com

SIZE A4 PPROJECTION

DESCRIPTION: