

parts no.	DIM. a	DIM. b	inner thread	outer thread
B	4.8	11.8	4#40	4#40
D	5.8	12.0	4#40	4#40

SPECIFICATION

MATERIAL

Insulator: Thermail Plastic UL94-0
 Contacts: Copper Alloy
 Shell: Steel
 Rivet Boardlock: Copper Alloy
CONTACT PLATING
 Underplate: 50u"~100u" Nickel
 Contact Area: 1u"~30u" Selective Gold

ELECTRICAL

Operation voltage: 250 VAC max.
 Current rating: 3 Amps max.
 Contact resistance: 15 mohms max.
 Insulation resistance: 3000 Mohms min @ 500 VDC
 Dielectric withstanding voltage: 1000 VAC / minute
 Operating temperature: -55°C TO +105°C

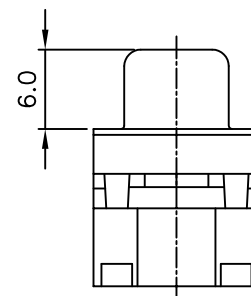
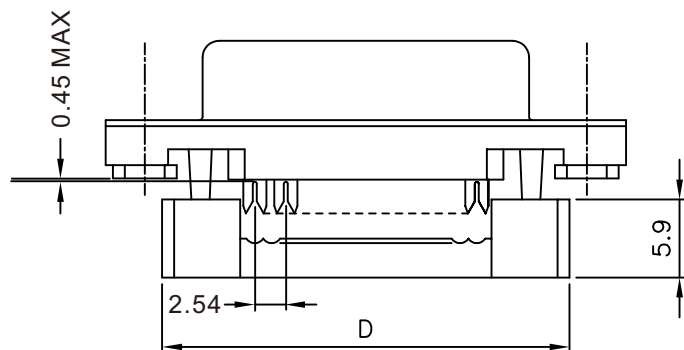

POSITION	A	B	C	D
DFM-SNH-09	16.30	25.00	30.8	22.4
DFM-SNH-15	24.60	33.30	39.2	30.8
DFM-SNH-25	38.30	47.10	53.1	44.5
DFM-SNH-37	54.80	63.50	69.4	61.4



RoHS Compliant

TOLERANCES ARE

MORETHANALL
 PCB CONNECTORS
 Cable ASSEMBLIES

DRAWING BY CY

X. ± 0.50

CHECKED BY GENIUS

.X ± 0.30

UNIT / mm

SCALE 1 : 1

.XX ± 0.20

DATE

.XXX ±

ANG ±

照片框

ORDER INFORMATION

DFM-SNH-xx-LF
 SERIES | | LEADFREE
 | | 09-37 WAY
 | | HEX SCREW
 | | NUT
 | | FEMALE

煜倫股份有限公司

www.morethanall.com

SIZE A4

PPOJECTION

DESCRIPTION: D型 母壓排 鉚螺母 附螺絲