

**SPECIFICATIONS**  
 Current Rating: 1A AC,DC  
 Voltage Rating: 150V AC,DC  
 Temperature Range: -25°C ~ +85°C  
 Contact Resistance: 30mΩ Max.  
 Insulation Resistance: 500MΩ Min.  
 Withstanding Voltage: 500V AC/minute  
 Pin Material: Brass/Gold-flash  
 Solder Tabs: Phosphor Bronze/Gold-flash  
 Material: Nylon 6T,UL94V-0  
 Color: Natural(Beige)

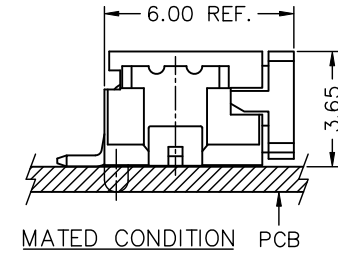
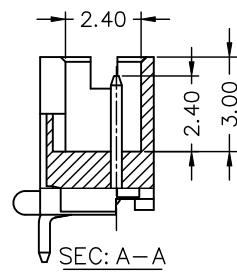
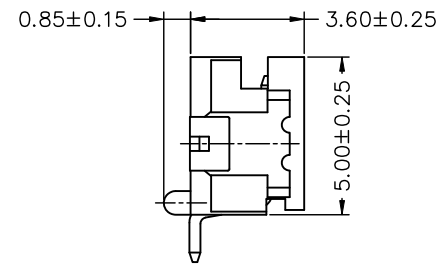
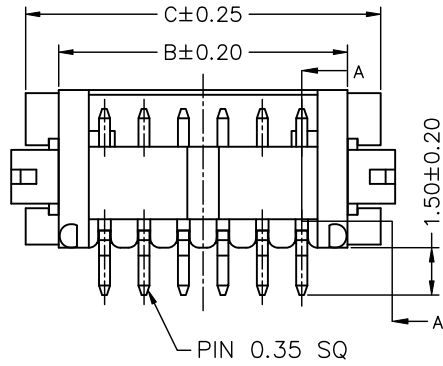

Circuit No.	Dimensions			
	A	B	C	D
02P	1.25	4.15	6.25	—
03P	2.50	5.40	7.50	—
04P	3.75	6.65	8.75	4.38
05P	5.00	7.90	10.00	5.63
06P	6.25	9.15	11.25	6.88
07P	7.50	10.40	12.50	8.13
08P	8.75	11.65	13.75	9.38
09P	10.00	12.90	15.00	10.63
10P	11.25	14.15	16.25	11.88
11P	12.50	15.40	17.50	13.13
12P	13.75	16.65	18.75	14.38
13P	15.00	17.90	20.00	15.63
14P	16.25	19.15	21.25	16.88
15P	17.50	20.40	22.50	18.13

RoHS Compliant

TOLERANCES ARE



DRAWING BY CY

CHECKED BY GENIUS

UNIT / mm SCALE 1 : 1

DATE

SIZE A4 PPROJECTION

X, ±  
 .X ± 0.25  
 .XX ± 0.15  
 .XXX ± 0.05  
 ANG ±

煜倫股份有限公司

www.morethanall.com

照片框

ORDER INFORMATION

DF13-WP-1Xxx-LF

SERIES | LEADFREE  
 1X02:02 WAY  
 1X15:15 WAY  
 POST  
 90°SMT

DESCRIPTION: 1.25mm PITCH 90° SINGLE ROW WAFER SMT TYPE