

- Material: \* Insulator: Nylon 6T UL 94V-0 (Milky Yellow)  
 \* Contact Post: Phosphor Bronze, Matte Tin Plated  
 \* Solder Tab: 0.20mm<sup>t</sup> Brass, Matte Tin Plated

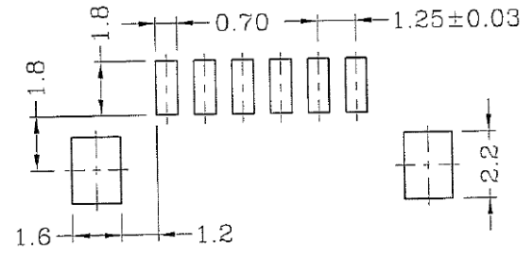

P.C.B LAYOUT

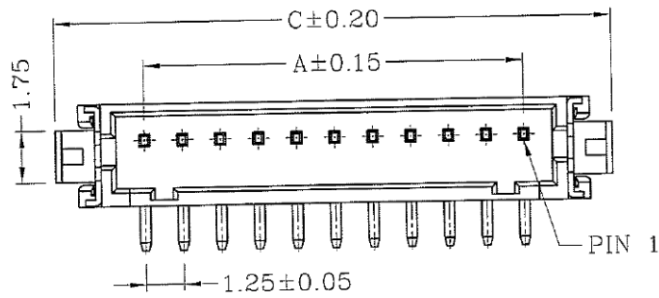
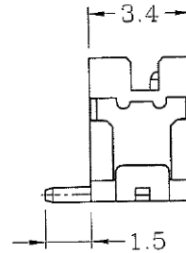
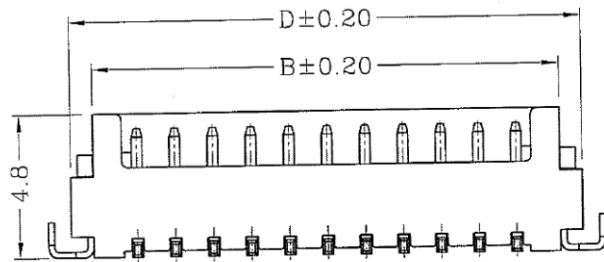

Dimensional & Ordering Information:

Part	Dimensions				Pcs/Reel
	A	B	C	D	
2	1.25	4.15	7.15	5.65	1000
3	2.50	5.40	8.40	6.90	1000
4	3.75	6.65	9.65	8.15	1000
5	5.00	7.90	10.90	9.40	1000
6	6.25	9.15	12.15	10.65	1000
7	7.50	10.40	13.40	11.90	1000
8	8.75	11.65	14.65	13.15	1000
9	10.00	12.90	15.90	14.40	1000
10	11.25	14.15	17.15	15.65	1000
11	12.50	15.40	18.40	16.90	1000
12	13.75	16.65	19.65	18.15	1000
13	15.00	17.90	20.90	19.40	1000
14	16.25	19.15	22.15	20.65	1000
15	17.50	20.40	23.40	21.90	1000

RoHS Compliant

TOLERANCES ARE

**MORETHANALL**  
 PCB CONNECTORS  
 Cable ASSEMBLIES

DRAWING BY CY

CHECKED BY GENIUS

UNIT / mm SCALE 1:1

DATE

SIZE A4

X, ±  
 .X ±  
 .XX ±  
 .XXX ±  
 ANG ±

P PROJECTION

照片框

ORDER INFORMATION

DF13-VX-1Xxx-LF

SERIES | LEADFREE  
 | 1X02:02WAY  
 | 1X15:15WAY  
 | NON POST  
 | 180°SMT

煜倫股份有限公司

www.morethanall.com

DESCRIPTION: