

PCB LAYOUT

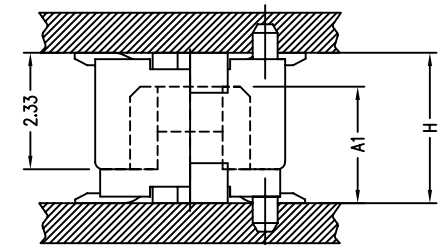
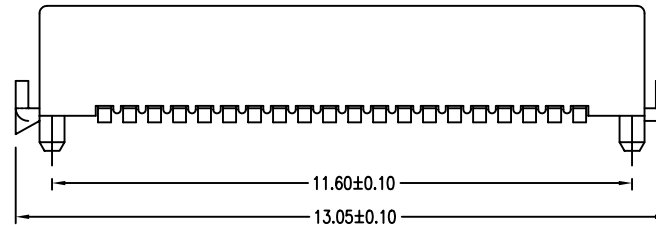

Mating Draw (Ref)

Specifications

1. Current Rating : 0.5A AC/DC
2. Voltage Rating : 50V AC/DC
3. Contact Resistance : 30m ohm. max.
4. Insulation Resistance : 100M ohm. min.at 100V DC
5. Withstanding Voltage : 100V AC for one minute
6. Operating Temperature Range : $^{\circ}\text{C}20$ to $+105^{\circ}\text{C}$

Material and Plating

- 1.Housing : LCP (Natural Color)UL94V-0
- 2.Contact : Phosphor Bronze
- 3.Plating : 3u" Gold Flash

Number of Connectors:1500pcs/Reel

**Mating Dimension

| P/N(Male) | P/N(Female) | Male Height Dim A1 | Mating Height Dim H |
|---------------|---------------|--------------------|---------------------|
| DF12-P23A-040 | DF12-S07A-040 | 2.33 | 3.00 |
| DF12-P23A-040 | DF12-S27A-040 | 4.33 | 5.00 |

MORETHANALL
CONNECTORS
ASSEMBLIES

煜倫有限公司

PART NO. DF12-P23A-040

DWG NO. DF12-P23A-040

FILE NO.

UNIT / mm

SCALE 1:1

APPROVED BY CY

DRAWING BY

PROJECTION

TOLERANCES ARE

.X ±0.20

.XX ±0.15

.XXX

AWG

DESCRIPTION:

0.5mm Board To Board Male
2.2mm High With Metal Tab

AREA

REVISIONS

HK

DATE