

Specifications

Contact Resistance: $\leq 30m$ max. at DC
100mA
Insulator Resistance: 1000M min. at DC
500V
Current Rating: 5 AMP
Dielectric Withstanding
Voltage: AC 1000V For 1 minute
Operating Temperature: $-55^{\circ}C \sim +235^{\circ}C$
Contact: PHOSPHOR BRONZE, SEMI-GOLD
Housing: NYLON 6T

MALE

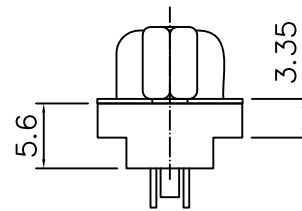
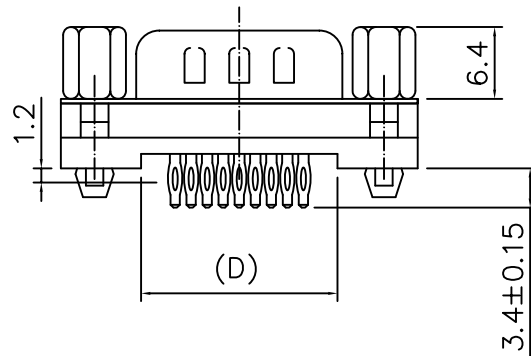

Dimension

Position	A	B	C	D
*09	30.81	24.99	16.92	16.96
15	39.14	33.32	25.50	25.18
25	53.04	47.04	38.96	39.12
37	69.32	63.50	55.42	55.68

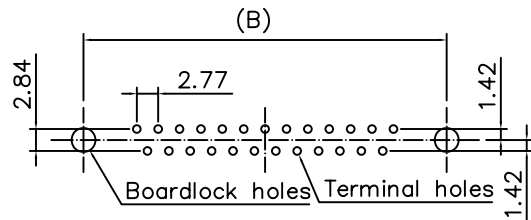

Recommended PCB Layout

Boardlock Specification:

Drilled hole	3.3 ± 0.02
Finished hole	3.2 ± 0.05
Cu	Min 25 μm
Sn	5-15 μm

Terminal Specification:

Drilled hole	1.2 ± 0.02
Finished hole	1.1 ± 0.05
Cu	Min 25 μm
Sn	5-15 μm

RoHS Compliant

TOLERANCES ARE

MORETHANALL
PCB CONNECTORS
Cable ASSEMBLIES

煜倫股份有限公司

www.morethanall.com

DRAWING BY CY

CHECKED BY GENIUS

UNIT / mm SCALE 1 : 1

DATE

SIZE A4

X. \pm
.X \pm
.XX \pm
.XXX \pm
ANG \pm

PJECTION

照片框

ORDER INFORMATION

DDP-PZJ-xx-LF
SERIES | LEADFREE
| 09-37WAY
| JACKSCREW
| CLIP
| MALE

DESCRIPTION: D-SUB STRAIGHT PRESS-FIT TYPE